

UB-Series

Description

The Ultra Block ® (UB-Series) expansion and construction joint fire stop system, is a pre-engineered, patented, flexible textile fiberglass roll material with a fiberglass matte facing, containing approximately 30% by weight unexpanded vermiculite.

When the UB-Series fire stop is used together with an approved sealant, it will provide a 2-hour, 3-hour, or 4-hour fire rated joint system as designated by design configuration. The system is capable of withstanding +/- 50% expansion and contraction. Most sealant manufacturers in the United States have tested one or more of their sealants in a UL® classified Ultra Block ® system ranging in joint size from 1/2” up to 7”.

LEED Credits - One (1) LEED credit depending on the location of the project.

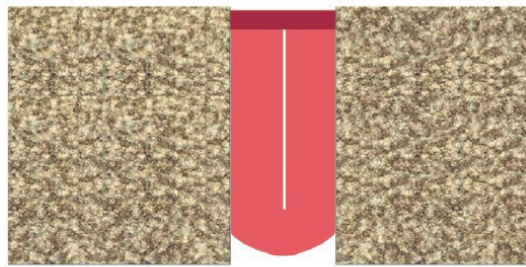

UB-Series installed in joint opening

Physical Properties

The Ultra Block ® system has a very unique feature not present in either mineral wool or ceramic fiber material. It contains vermiculite, which expands when exposed to heat. As the vermiculite expands, it produces thousands of reflective shields that reflect heat back away from the expansion joint. When exposed to fire on the caulked and un-caulked side, there is no passage of destructive heat to the sealant bead on the opposite side.

Features and Benefits

Compatible – The system is adaptable to many applications and can be used with most of the EMS expansion joint products.

Easy to Install – Requires no cutting, fitting or fabrication. Simply open the bag, unwind the roll, fold in half with the matte side facing outward, compress and slide it into the joint to the required depth. Apply sealant per manufacturer’s instructions.

Extensively Tested– Tested to various standards including UBC, BOCA, SBCCI, UL, ASTM and NFPA.

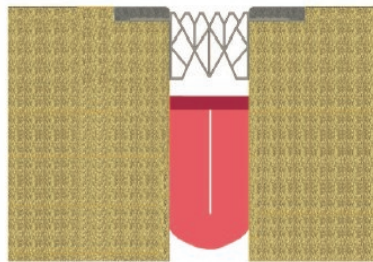

UB-Series installed with wing joint

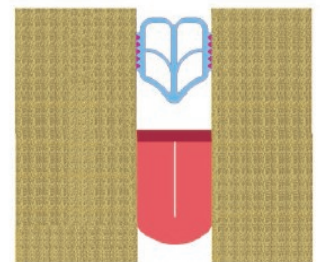

UB-Series installed with compression seal

PRODUCT	MIN. WIDTH IN (MM)	MID RANGE IN (MM)	MAX. WIDTH IN (MM)	DEPTH IN (MM)	TOTAL MOVEMENT IN (MM)
UB-200	0.62” (15.7)	1.38” (35.1)	2.00” (50.8)	4.50” (114.3)	1.38” (35.1)
UB-250	0.75” (19.1)	1.75” (44.5)	2.50” (63.5)	4.50” (114.3)	1.75” (44.5)
UB-300	1.00” (25.4)	2.00” (50.8)	3.00” (76.2)	4.50” (114.3)	2.00” (50.8)
UB-400	1.25” (31.8)	2.75” (69.9)	4.00” (101.6)	4.50” (114.3)	2.75” (69.9)
UB-450	1.50” (38.1)	3.00” (76.2)	4.50” (114.3)	5.00” (127.0)	3.00” (76.2)
UB-500	1.62” (41.1)	3.38” (85.9)	5.00” (127.0)	5.00” (127.0)	3.38” (85.9)
UB-550	1.75” (44.5)	3.75” (95.3)	5.50” (139.7)	5.00” (127.0)	3.75” (95.3)
UB-600	2.00” (50.8)	4.00” (101.6)	6.00” (152.4)	5.00” (127.0)	4.00” (101.6)
UB-700	2.25” (57.2)	4.75” (120.7)	7.00” (177.8)	5.00” (127.0)	4.75” (120.7)