

EWJ-Series-400 Wall to Wall Application

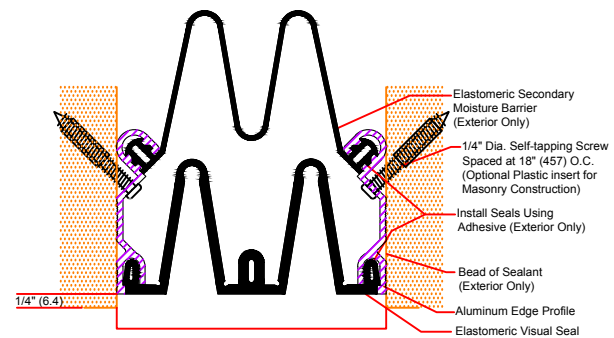

EWJ-Series-300 Wall to Wall Application

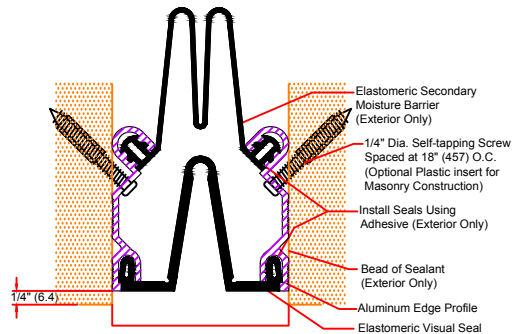

EWJ-Series-200 Wall to Wall Application

PRODUCT	Joint Opening IN (MM)	Total Movement IN (MM)
EWJ-200	2.00" (50.8)	2.63" (66.8)
EWJ-300	3.00" (76.2)	5.13" (130.3)
EWJ-400	4.00" (101.6)	4.75" (120.7)

NO.	Description	Date	By
<small>The information contained herein is the proprietary property of ERIE METAL SPECIALTIES, INC. No portion of it may be reproduced by any means or used in any form except for the purpose for which it was intended. All rights of design and invention are hereby reserved.</small>			



13311 Main Road \* Akron \* New York \* 14001  
 Phone: (716) 542-3991 \* Fax: (716) 542-3996 \* E-mail: sales@eriemetal.com

PROJECT: N/A

TITLE: EWJ-Series Wall to Wall Application

Detailed by:	Date:
BAF	07/20/16
Checked by:	Date:
SLP	07/22/16
Scale:	EMS Job #:
NTS	N/A
Sheet No.:	Drawing No.:
1 of 1	EWJ-1

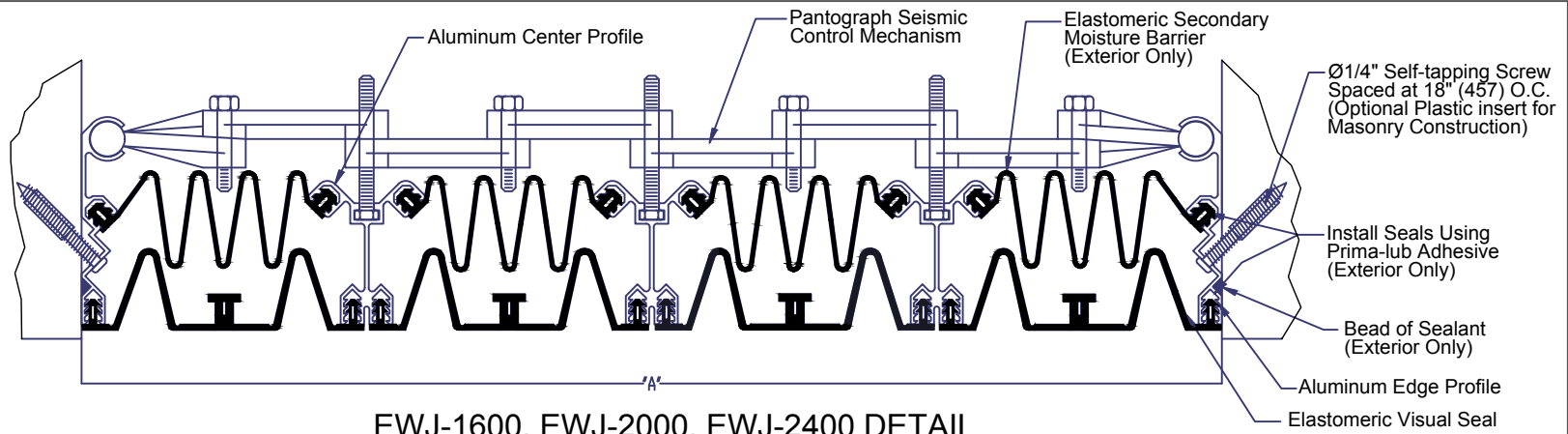

**EWJ-1600, EWJ-2000, EWJ-2400 DETAIL**  
EXTERIOR APPLICATION / WALL TO WALL

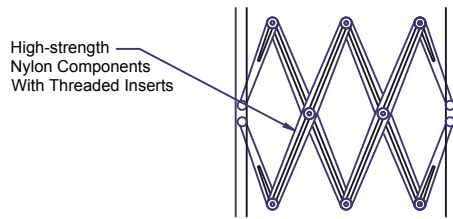

**PLAN VIEW**  
PANTOGRAPH CONTROL MECHANISM

\* Designed Without Stress To The System Components.  
Capable Of Wider Movement During Seismic Events.

\* Contact EMS for additional information.

PRODUCT EWJ-Series	"A" Min. Width IN (MM)	"A" Mid Range IN (MM)	"A" Max. Width IN (MM)	Total Movement IN (MM)
EWJ-1600	12" (305)	16" (406)	31" (787)	19" (483)
EWJ-2000	8" (203)	20" (508)	35" (889)	27" (686)
EWJ-2400	8" (203)	24" (610)	46" (1168)	38" (965)

NO.	Description	Date	By

The information contained herein is the proprietary property of ERIE METAL SPECIALTIES, INC. No portion of it may be reproduced by any means or used in any form except for the purpose for which it was intended. All rights of design and invention are hereby reserved.



13311 Main Road \* Akron \* New York \* 14001  
Phone: (716) 542-3991 \* Fax: (716) 542-3996 \* E-mail: sales@eriemetal.com

PROJECT:

TITLE:

Detailed by:	Date:
Checked by:	Date:
Scale: NTS	EMS Job #:
Sheet No.:	Drawing No.: