

# EFA150/EFDW Series Flooring Infill System

Interior Joints (Floor)

The Single Wing Hinged Flooring Infill System is designed with a hinged cover to accommodate horizontal and vertical thermal movement. This surface mounted system is designed to integrate with carpet and VCT flooring and provides a minimal sight line.

## FEATURES

**HINGED DESIGN** Constructed with a single wing, hinged design to allow for limited vertical movement.

**INTEGRATED FLOORING** Designed to coordinate with main flooring material and accepts floor infill.

**SURFACE MOUNT** No block out is required. Simply screw onto subfloor.

## DETAILS

**MATERIAL** 6063-T6 Aluminum

**FINISH** Mill

## MOVEMENT

- Thermal: Horizontal and Vertical

**MOUNTING** Surface

**JOINT SIZE** 3 inches

**LENGTH** 10 Linear Feet

**LOAD** Pedestrian and Light Cart

**INSTALLATION** Floor

**OPTIONS** Moisture Barrier, Fire Barrier

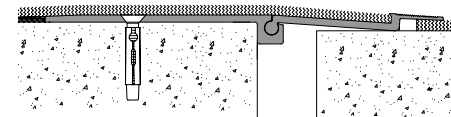
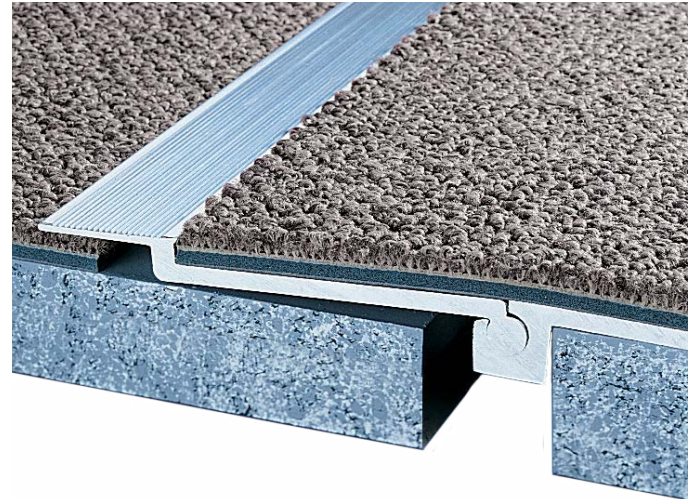

Floor-to-Floor

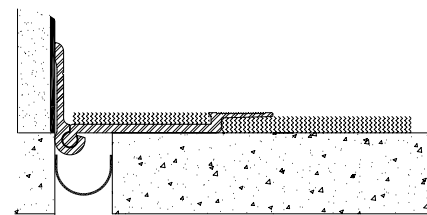

Floor-to-Wall/Corner

## MODELS

MODEL	INSTALLATION	JOINT SIZE AT MEAN T°F	EXPOSED SIGHT-LINE	FLOOR INFILL HEIGHT	MOVEMENT
EFA150-375	Floor-to-Floor	3" (76mm)	1.5" (38mm)	0.125" (3mm)	1" (25mm)
EFDW-125	Floor-to-Wall	3" (76mm)	1.5" (38mm)	0.125" (3mm)	1" (25mm)
EFA150-250	Floor-to-Floor	3" (76mm)	1.5" (38mm)	0.25" (6mm)	1" (25mm)
EFDW-250	Floor-to-Wall	3" (76mm)	1.5" (38mm)	0.25" (6mm)	1" (25mm)
EFA150-375	Floor-to-Floor	3" (76mm)	1.5" (38mm)	0.375" (10mm)	1" (25mm)
EFDW-375	Floor-to-Wall	3" (76mm)	1.5" (38mm)	0.375" (10mm)	1" (25mm)



Erie Metal Specialties, Inc.  
13311 Main Road  
Akron, NY 14001

Phone: 716-542-3991  
Website: [www.eriametal.com](http://www.eriametal.com)  
E-Mail: [sales@eriametal.com](mailto:sales@eriametal.com)