

EFLC Series Flooring System

Interior Joints (Floor)

This metal floor cover is designed for interior applications where low maintenance or tamper-resistant applications are desirable. With a recessed side frame and sloped center plate, this model helps reduce visual line as compared to other metal floor covers.

FEATURES

DURABLE The seismic glide system is an ideal option for commercial environments.

MINIMAL SIGHT LINE With the sliding surface, the sight line remains limited and unchanged as the joint moves.

COORDINATING CORNERS Available with a corner option for a complete floor solution.



DETAILS

MATERIAL 6063-T6 Aluminum

FINISH Mill

MOVEMENT

- Thermal: Horizontal and Vertical
- Seismic: Lateral Shear

MOUNTING Block Out

JOINT SIZE 1 inch to 6 inches

LENGTH 10 Linear Feet

APPLICATION Interior

LOAD Pedestrian and Light Cart

INSTALLATION Floor

OPTIONS Moisture Barrier, Fire Barrier

MODELS

MODEL	INSTALLATION	JOINT SIZE AT MEAN T°F	SYSTEM WIDTH	TOTAL MOVEMENT
EFLC-100	Floor-to-Floor	1" (25mm)	9.69" (246mm)	1" (25mm)
EFLC-100W	Floor-to-Wall	1" (25mm)	7.31" (186mm)	2" (51mm)
EFLC-200	Floor-to-Floor	2" (51mm)	9.69" (246mm)	2" (51mm)
EFLC-200W	Floor-to-Wall	2" (51mm)	7.31" (186mm)	2" (51mm)
EFLC-400	Floor-to-Floor	4" (102mm)	9.69" (246mm)	4" (102mm)
EFLC-400W	Floor-to-Wall	4" (102mm)	7.31" (186mm)	4" (102mm)
EFLC-600	Floor-to-Floor	6" (152mm)	13.63" (346mm)	6" (152mm)
EFLC-600W	Floor-to-Wall	6" (152mm)	11.25" (286mm)	6" (152mm)

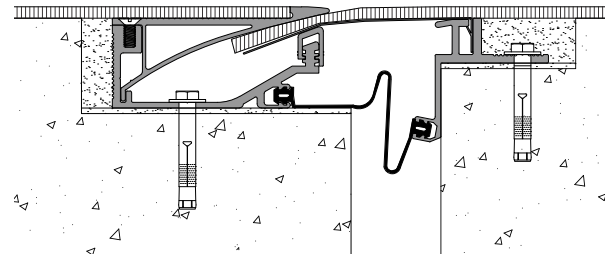

Floor-to-Floor

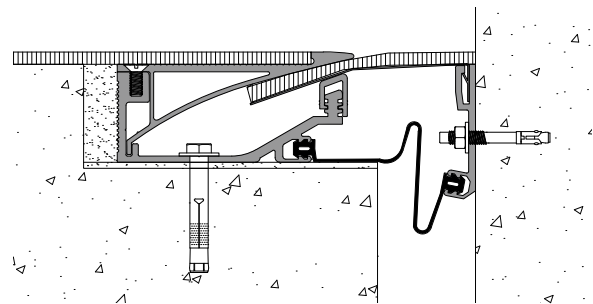

Floor-to-Wall/Corner



Erie Metal Specialties, Inc.
13311 Main Road
Akron, NY 14001

Phone: 716-542-3991
Website: www.eriametal.com
E-Mail: sales@eriametal.com