

# ELCH Series Corridor System

## Interior Joints (Wall)

The Seismic Elastomeric Corridor System is a system dedicated to limiting the sight line of the expansion joint by mounting inside the joint opening, and allows a color selection to match your surrounding substrate and finish material. This system accommodates seismic movement.

### FEATURES

- MAXIMUM MOVEMENT** Deep "V" design allows for maximum thermal and seismic movement.
- COMPLEMENTARY SEAL COLORS** Available in four elastomeric seal color options: beige, white, gray or black.
- CONTINUOUS SIGHT LINE** This system can be used on walls, ceilings and corners to provide seamless and continuous aesthetics.



### DETAILS

**MATERIAL** 6063-T6 Aluminum with Rubber Seal

**FINISH** Mill

#### MOVEMENT

- Thermal: Horizontal and Vertical
- Seismic: Lateral Shear

**MOUNTING** Flush

**JOINT SIZE** 1 inch to 6 inches

**SEAL LENGTH** Continuous

**APPLICATION** Interior

**INSTALLATION** Wall or Ceiling

**OPTIONS** Seal Color

### SEAL COLORS

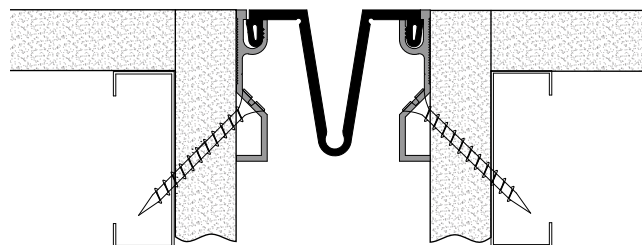

Wall/Ceiling Corner

### MODELS

| MODEL    | INSTALLATION                        | JOINT SIZE AT MEAN T°F | SYSTEM WIDTH | TOTAL MOVEMENT |
|----------|-------------------------------------|------------------------|--------------|----------------|
| ELCH-100 | Wall-to-Wall or Wall/Ceiling Corner | 1" (25mm)              | 1" (25mm)    | 0.5" (13mm)    |
| ELCH-200 | Wall-to-Wall or Wall/Ceiling Corner | 2" (51mm)              | 2" (51mm)    | 2" (51mm)      |
| ELCH-300 | Wall-to-Wall or Wall/Ceiling Corner | 3" (76mm)              | 3" (76mm)    | 3" (76mm)      |
| ELCH-400 | Wall-to-Wall or Wall/Ceiling Corner | 4" (102mm)             | 4" (102mm)   | 4" (102mm)     |
| ELCH-500 | Wall-to-Wall or Wall/Ceiling Corner | 5" (127mm)             | 5" (127mm)   | 5" (127mm)     |
| ELCH-600 | Wall-to-Wall or Wall/Ceiling Corner | 6" (152mm)             | 6" (152mm)   | 6" (152mm)     |

