

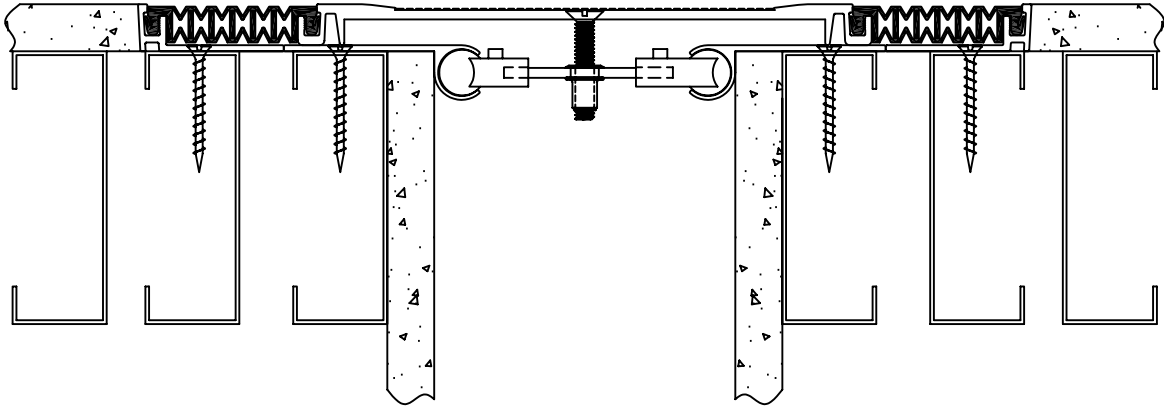

Erie Metal Specialties, Inc.
13311 Main Road
Akron, NY 14001

Phone: 716-542-3991
Website: www.eriemetal.com
E-Mail: sales@eriemetal.com



Seismic Plus - Professional Series Model(s) "ESWNB-400 thru 2400" Vertical Expansion Control Systems

The following installation procedure is very important and must be fully understood prior to beginning any work. To ensure proper installation and performance of expansion joint systems the following actions must be completed by the installing contractor. Failure to do so will affect product warranty.

- 1) Carefully read and understand installation procedure. Contact Technical Service Department for product assistance.
- 2) Inspect all shipments and materials for missing or damaged components and hardware. Contact Customer Service with order number and invoice for prompt assistance.
- 3) Inspect substrate or adjacent construction for acceptance before beginning work. Report unacceptable construction to the project manager for scheduled repair work.

Standard Components



1/4" X 1 1/4" Lg Screw
P/n: 5621

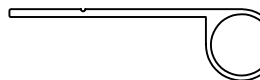

Aluminum Base Extrusion
P/n: 15244



Elastomeric Seal
P/n: 15340 (Black)
P/n: 15341 (Beige)
P/n: 15342 (Grey)



Rolling Tool
P/n: 15577

Components shown below vary in size depending on model of system

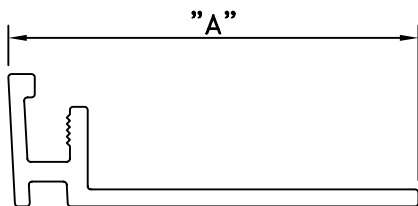

Aluminum Edge Extension
(Refer to Chart Below for sizes and P/n)

Model	P/N	"A"
ESWNB-400	15800	1 15/16"
ESWNB-600/800	15801	2 15/16"
ESWNB-1000/1200/1800/2400	15802	3 15/16"

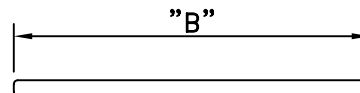

Filler Panel
(Refer to Chart Below for sizes and P/n)

Model	P/N	"B"
ESWNB-1800	15781	2 3/4"
ESWNB-2400	15872	4 1/4"

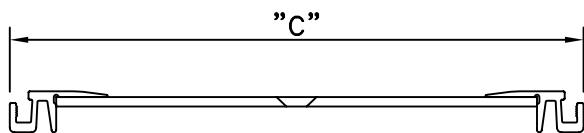

Aluminum Center Slide Plate
(Refer to Chart Below for sizes and P/n)

Model	P/N	"C"
ESWNB-400	15784	7 5/8"
ESWNB-600	15785	11 5/8"
ESWNB-800	15786	13 5/8"
ESWNB-1000	15787	17 5/8"
ESWNB-1200	15788	19 5/8"
ESWNB-1800	15789	29 1/8"
ESWNB-2400	15790	38 1/8"

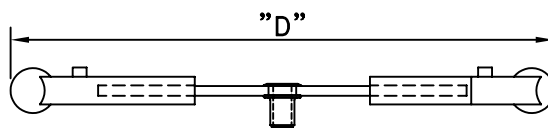

Seismic Centering Bar
(Refer to Chart Below for sizes and P/n)

Model	P/N	"D"
ESWNB-400	15630	18 3/8"
ESWNB-600	15630	18 3/8"
ESWNB-800	15630	18 3/8"
ESWNB-1000	15631	22 3/8"
ESWNB-1200	15631	22 3/8"
ESWNB-1800	15603	26 3/8"
ESWNB-2400	15641	50 3/8"

Installation Procedure

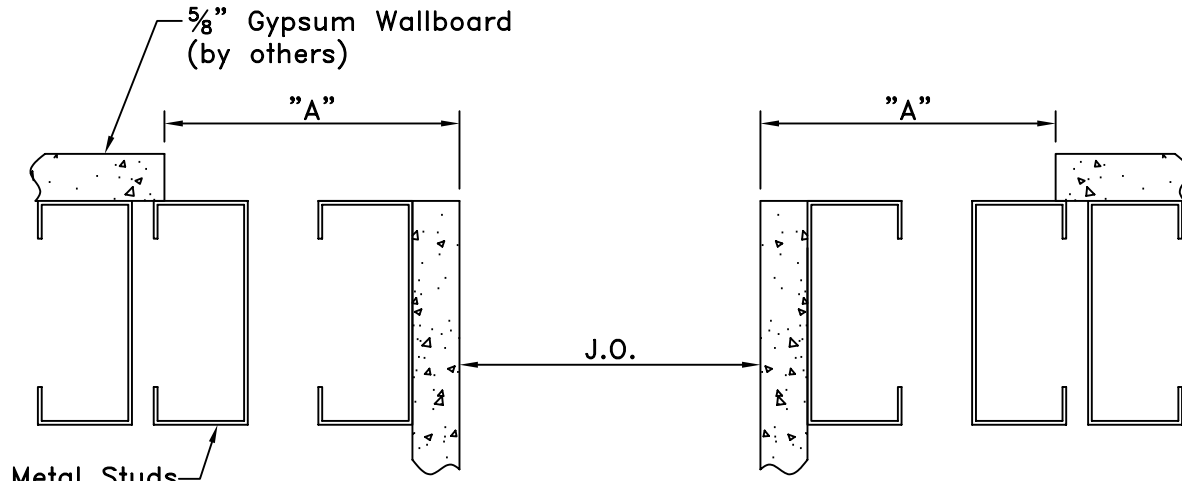

Metal Studs
(by others)

Model	"A"	J.O.
ESWNB-400	3 15/16"	4"
ESWNB-600	4 15/16"	6"
ESWNB-800	4 15/16"	8"
ESWNB-1000	5 15/16"	10"
ESWNB-1200	5 15/16"	12"
ESWNB-1800	7 11/16"	18"
ESWNB-2400	9 3/16"	24"

1

Prior to beginning work, installer shall inspect for proper wall construction. Verify joint opening as called for on chart.

Note: Non-Rated wall detail shown above. For rated wall installations, contact project architect to ensure that wall has been properly designed to maintain rating to accept Expansion Joint and Fire Barrier Systems.

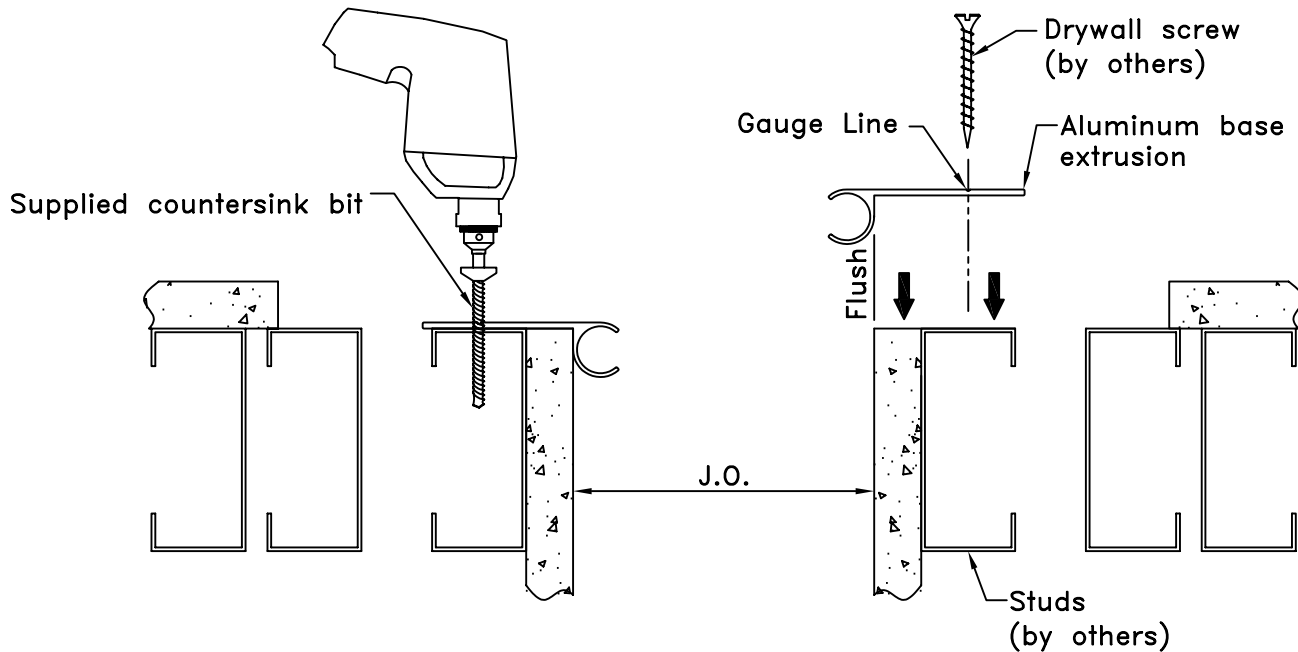

2

Place aluminum base extrusion on edge of opening as shown. Utilizing supplied countersink bit, drill through base extrusion at the gauge line and into stud. Fasten with drywall screws (by others) spaced at 24" O.C. maximum, start 12" from ends.

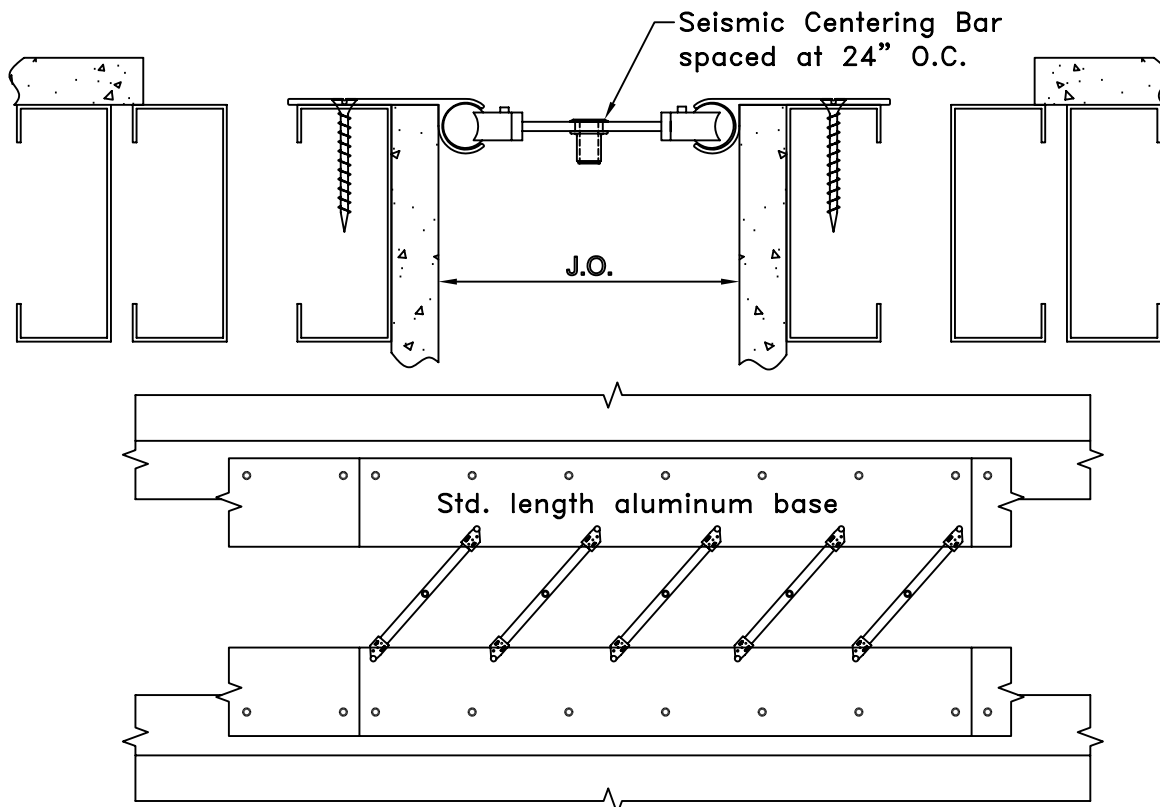

Typical Seismic Centering bar layout

3

As you install aluminum base member sections, slide Seismic Centering bars into circular cavities. Make sure that "TOP" indicator is facing out and that all bars are in same orientation. Utilize duct tape or something similar to hold bars in position and vertical spacing @ 24" O.C. until slide plate is installed.

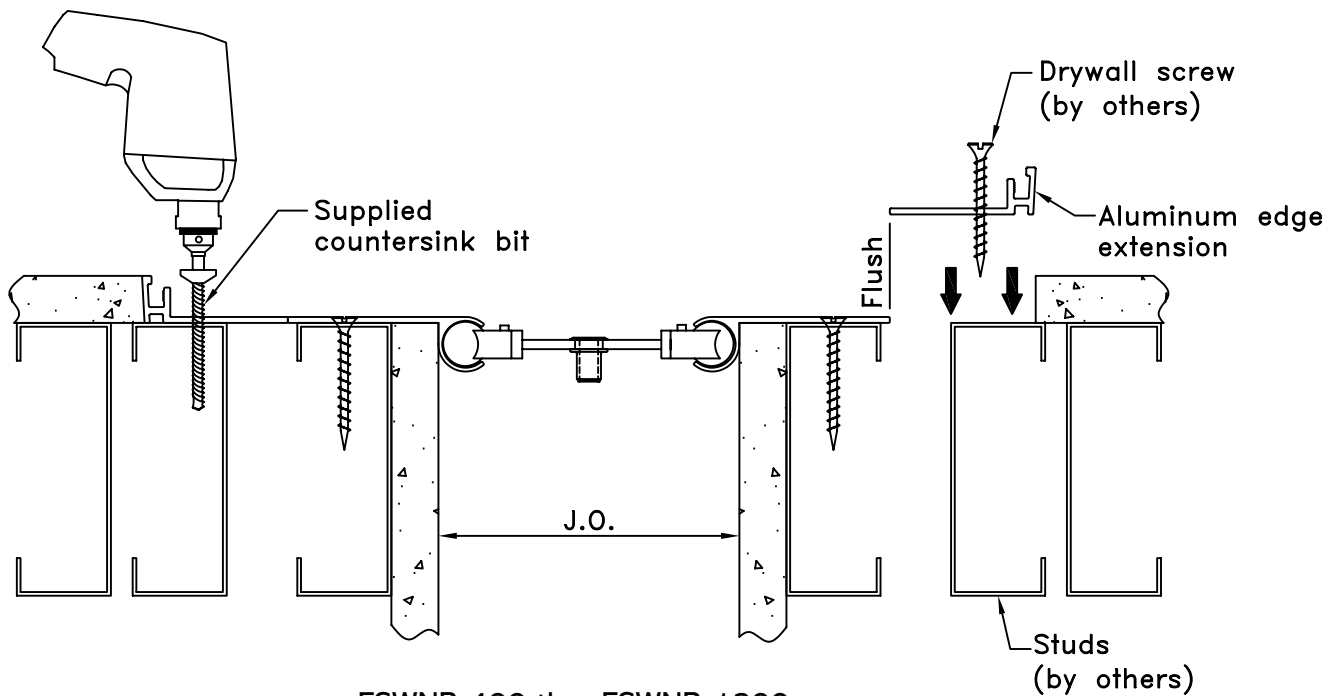

ESWNB-400 thru ESWNB-1200

4

Place aluminum edge extension flush with the edge of aluminum base extrusion as shown. Utilizing supplied countersink bit, drill through extrusion and into stud. Fasten with drywall screws (by others) spaced at 24" O.C. maximum, start 12" from ends.

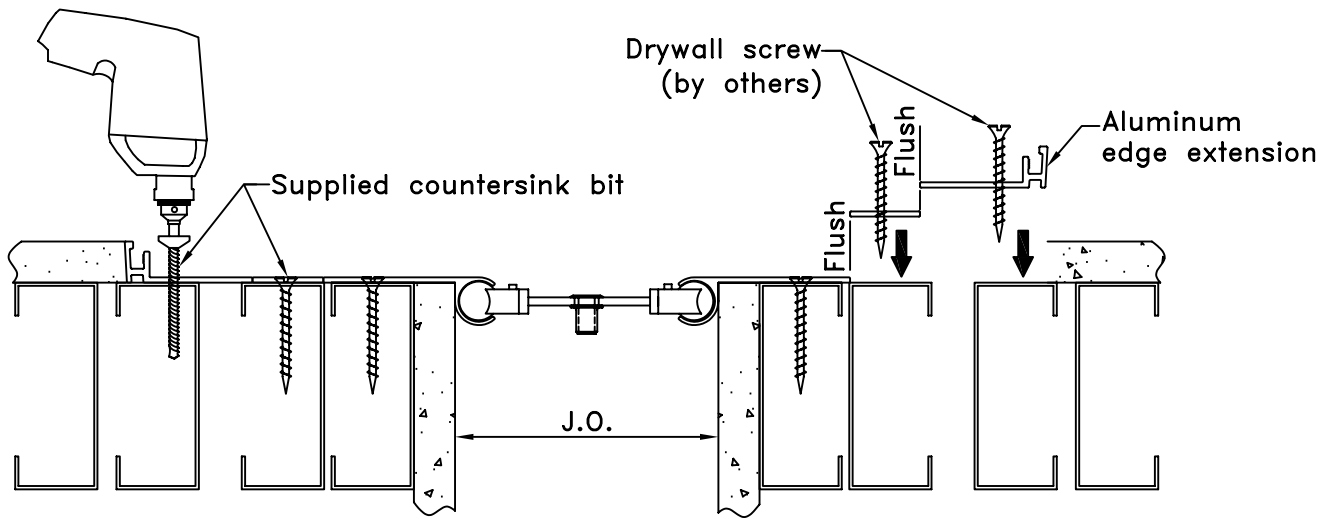

ESWNB-1800 thru ESWNB-2400

4A

Filler Plate

On ESWNB-1800 thru ESWNB-2400 systems, before aluminum edge extension can be installed, filler plates must be inserted flush with the edge of aluminum base extrusion as shown above. Utilizing supplied countersink bit, drill through extrusion and into stud. Fasten with drywall screws (by others) spaced at 24" O.C. maximum, start 12" from ends.

Aluminum Edge Extensions

After filler plate has been installed, place aluminum edge extension flush with the edge of filler plate as shown above. Utilizing supplied countersink bit, drill through extrusion and into stud. Fasten with drywall screws (by others) spaced at 24" O.C. maximum, start 12" from ends.

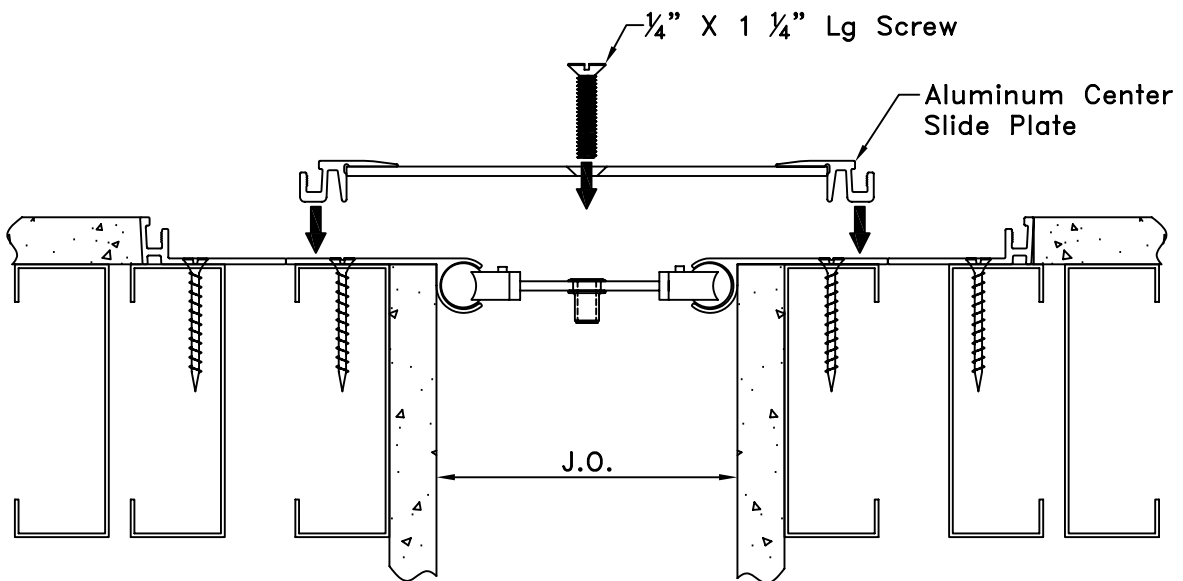

5

Position the Center Slide Plate over expansion opening, Align pre-drilled holes in slide plate with threaded insert in Seismic Centering bars. Fasten with $\frac{1}{4}$ " X $1\frac{1}{4}$ " Csk Flat Screw. Tighten to create measurable tension in the bar. Do Not Overtighten.

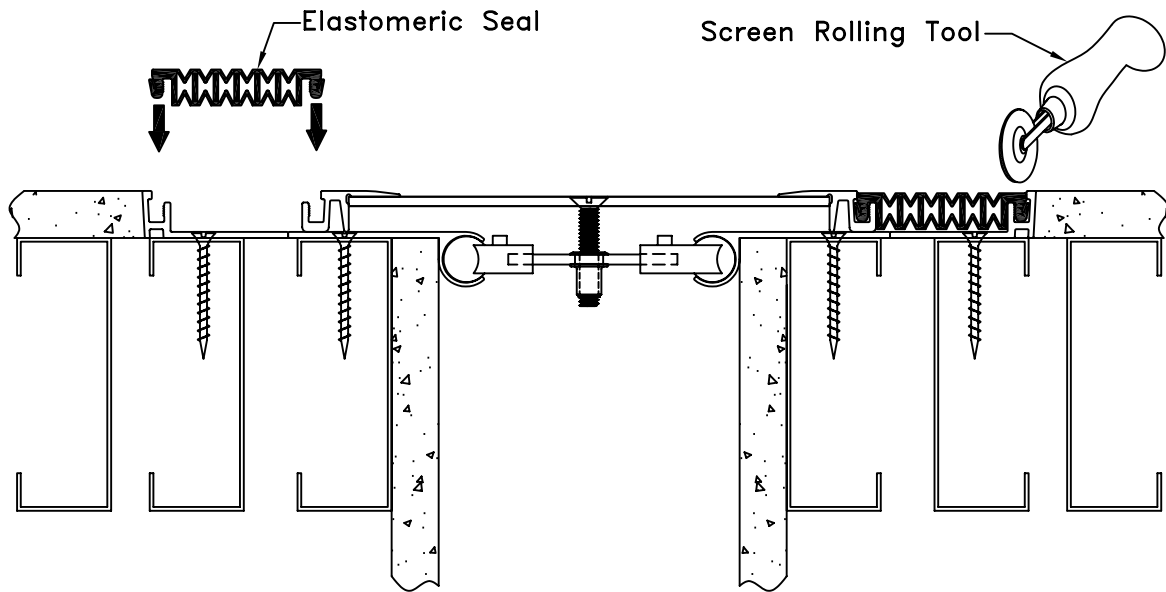

- 6 Position Seal lug over Extrusion cavity and insert lug into cavity using thumb pressure for initial insertion. Once Elastomeric Seal is inserted, run along top of lug with Screen rolling tool to ensure complete lug insertion.

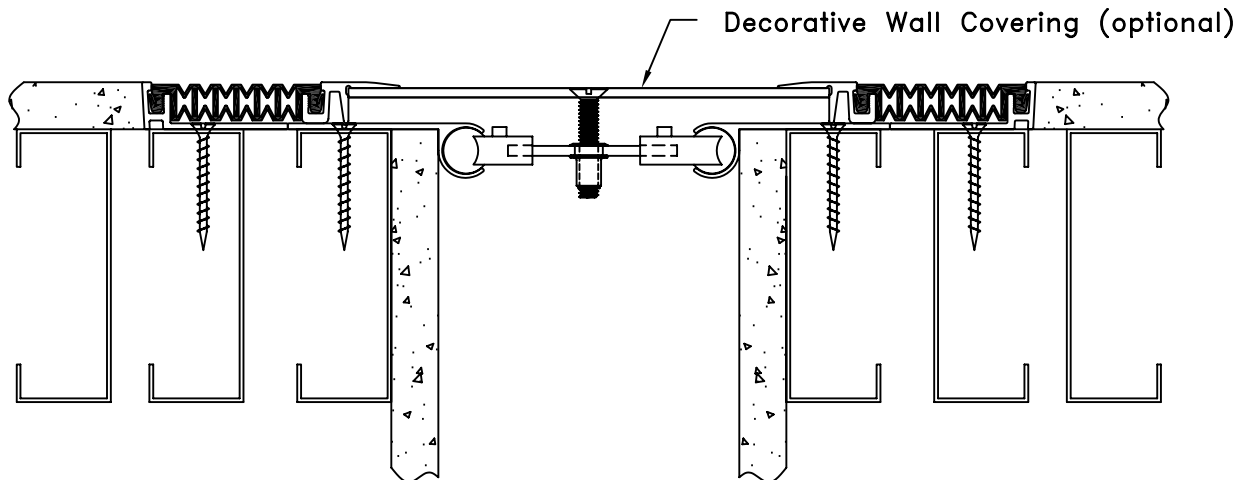

- 7 **Optional:**
Wipe down aluminum slide plate to remove dust particles prior to applying decorative wall covering materials.
Caution: Contact Wall Covering Materials Manufacturer to discuss product application and procedure for proper installation. Screw heads should be covered with tape to avoid slot in screw head from telegraphing through wall covering.



Erie Metal Specialties, Inc.
13311 Main Road
Akron, NY 14001

Phone: 716-542-3991
Website: www.eriemetal.com
E-Mail: sales@eriemetal.com

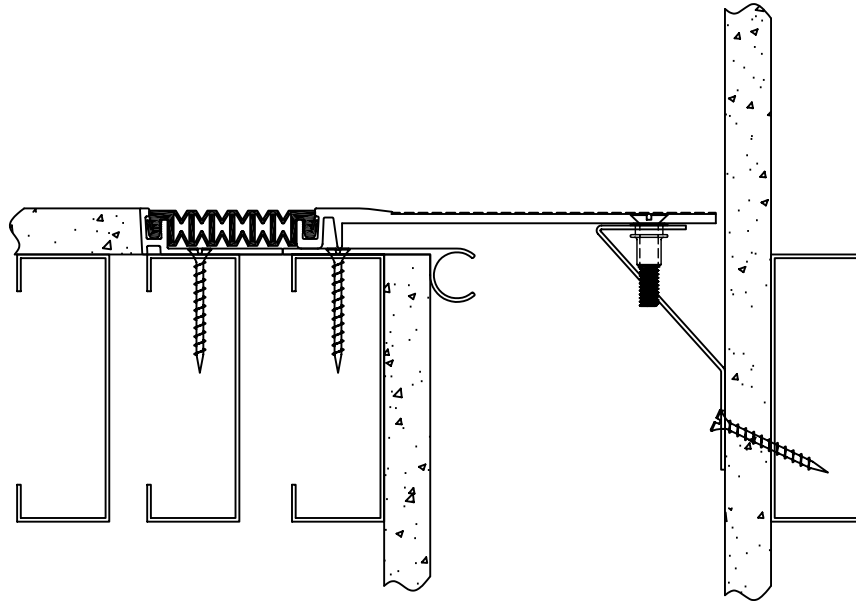

Seismic Plus - Professional Series Model(s) "ESWNB-400W thru 2400W" Vertical Expansion Control Systems

The following installation procedure is very important and must be fully understood prior to beginning any work. To ensure proper installation and performance of expansion joint systems the following actions must be completed by the installing contractor. Failure to do so will affect product warranty.

- 1) Carefully read and understand installation procedure. Contact Technical Service Department for product assistance.
- 2) Inspect all shipments and materials for missing or damaged components and hardware. Contact Customer Service with order number and invoice for prompt assistance.
- 3) Inspect substrate or adjacent construction for acceptance before beginning work. Report unacceptable construction to the project manager for scheduled repair work.

Standard Components



Elastomeric Seal
 P/n: 15340 (Black)
 P/n: 15341 (Beige)
 P/n: 15342 (Grey)



Aluminum Base Extrusion
 P/n: 15244

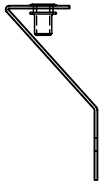

Corner Bracket
 P/n: 20661



1/4" X 1 1/4" Lg Screw
 P/n: 5621



Rolling Tool
 P/n: 15577

Components shown below vary in size depending on model of system

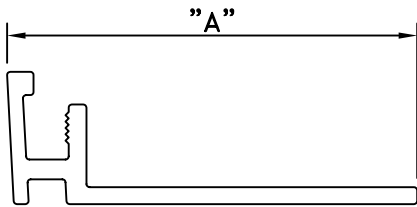

Aluminum Edge Extension
 (Refer to Chart Below for sizes and P/n)

Model	P/N	"A"
ESWNB-400W	15800	1 15/16"
ESWNB-600W/800W	15801	2 15/16"
ESWNB-1000W/1200W/ 1800W/2400W	15802	3 15/16"

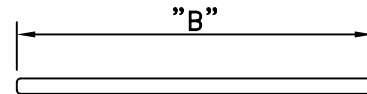

Aluminum Filler Panel
 (Refer to Chart Below for sizes and P/n)

Model	P/N	"B"
ESWNB-1800W	15781	2 3/4"
ESWNB-2400W	15872	4 1/4"

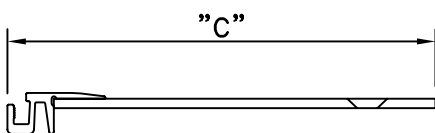

Aluminum Slide Plate
 (Refer to Chart at right for sizes and P/n)

Model	P/N	"C"
ESWNB-400W	15791	7 5/8"
ESWNB-600W	15792	11 5/8"
ESWNB-800W	15793	13 5/8"
ESWNB-1000W	15795	17 5/8"
ESWNB-1200W	15796	19 5/8"
ESWNB-1800W	15797	29 1/8"
ESWNB-2400W	15798	38 1/8"

Installation Procedure

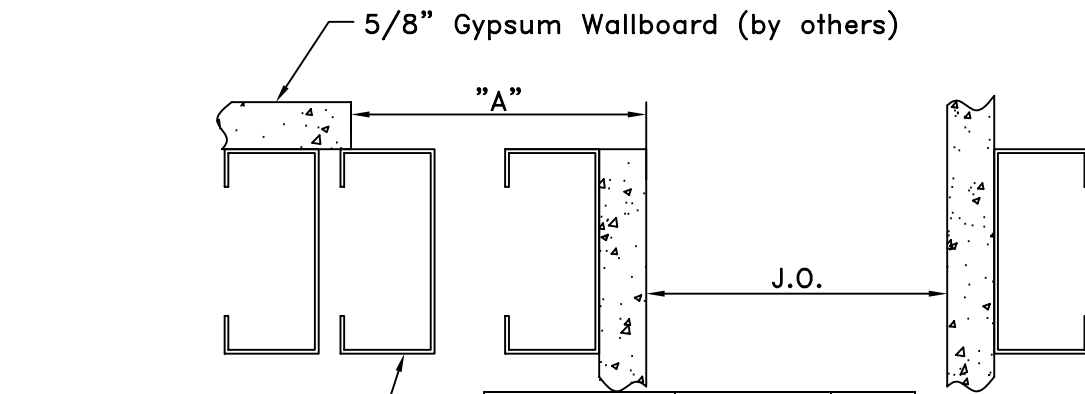

Model	"A"	J.O.
ESWNB-400W	3 15/16"	4"
ESWNB-600W	4 15/16"	6"
ESWNB-800W	4 15/16"	8"
ESWNB-1000W	5 15/16"	10"
ESWNB-1200W	5 15/16"	12"
ESWNB-1800W	7 11/16"	18"
ESWNB-2400W	9 3/16"	24"

1 Prior to beginning work, installer shall inspect for proper wall construction. Verify joint opening is as called for on chart.
Note: Non-Rated wall detail shown above. For rated wall installations, contact project architect to ensure that wall has been properly designed to maintain rating to accept Expansion Joint and Fire Barrier Systems.

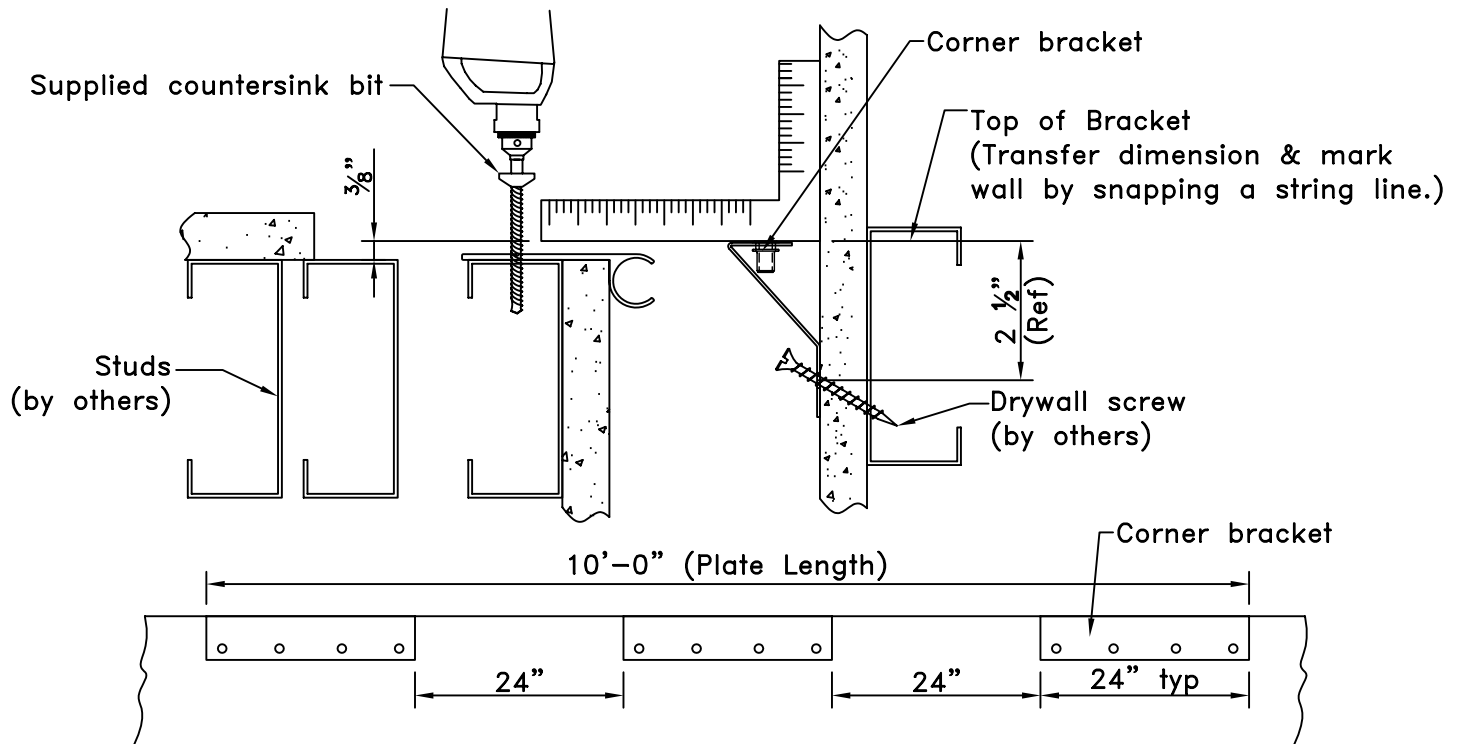

2 **Corner** – For ease of installation locate corner bracket first. Drill to wall construction and stud. Utilizing drywall screws (by others) mount Corner Bracket to wall with minimum (4) screws per corner bracket. Place aluminum base extrusion on edge of opening as shown. Utilizing supplied countersink bit, drill through base extrusion at gauge line into stud. Fasten with drywall screws (by others) spaced at 24" O.C. maximum, start 12" from ends.
Note: Corner Bracket supplied in 24" lengths. For a standard ten foot plate section (3) Corner brackets are required.

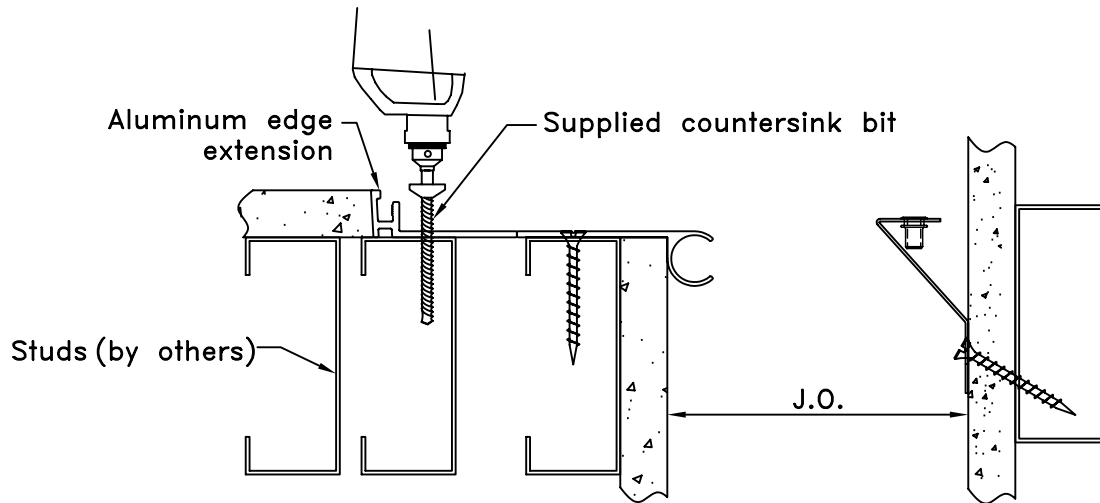

ESWNB-400W thru ESWNB-1200W

- 3** Place aluminum edge extension flush with the edge of aluminum base extrusion as shown. Utilizing supplied countersink bit, drill through extrusion and into stud. Fasten with drywall screws (by others) spaced at 24" O.C. maximum, start 12" from ends.

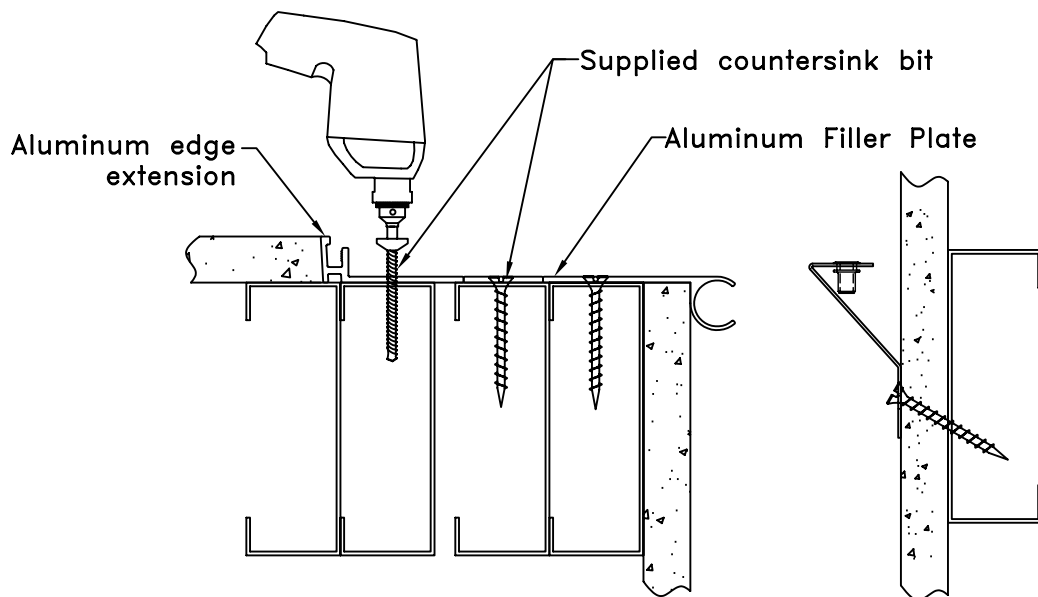

ESWNB-1800W thru ESWNB-2400W

- 3A** Filler Plate
On ESWNB-1800W thru ESWNB-2400W systems, before aluminum edge extension can be installed, filler plates must be inserted flush with the edge of aluminum base extrusion as shown above. Utilizing supplied countersink bit, drill through extrusion and into stud. Fasten with drywall screws (by others) spaced at 24" O.C. maximum, start 12" from ends.

Aluminum Edge Extensions

After filler plate has been installed, place aluminum edge extension flush with the edge of filler plate as shown above. Utilizing supplied countersink bit, drill through extrusion and into stud. Fasten with drywall screws (by others) spaced at 24" O.C. maximum, start 12" from ends.

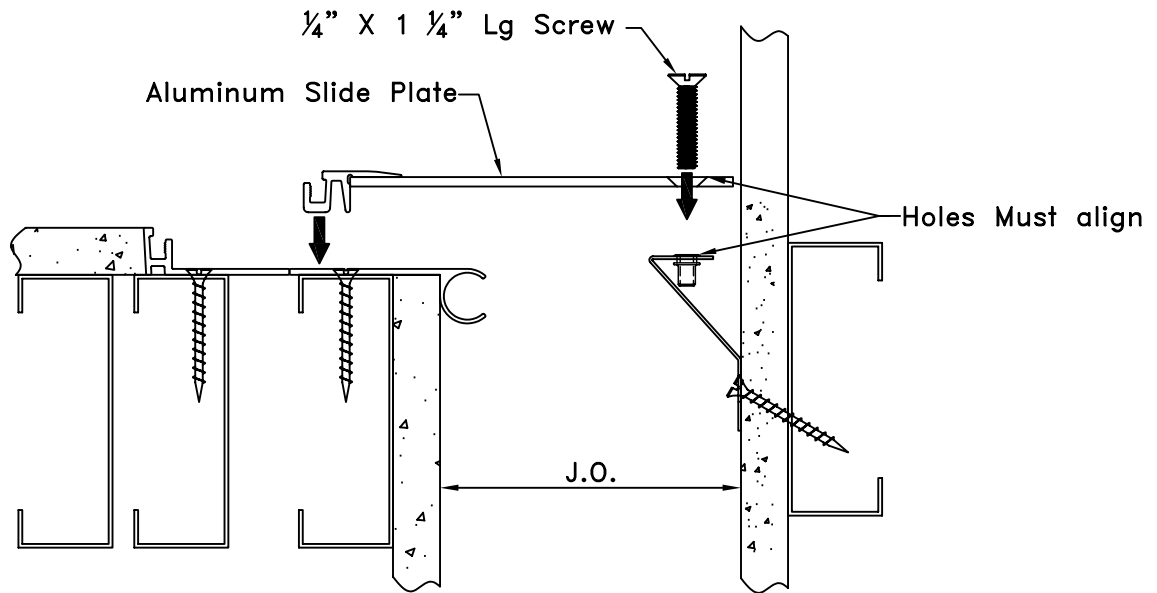

4

Position Slide Plate over expansion opening, Align pre-drilled holes in slide plate with threaded insert in Corner Bracket. Fasten with 1/4" X 1-1/4" Csk Flat Screw. Tighten to create measurable tension.

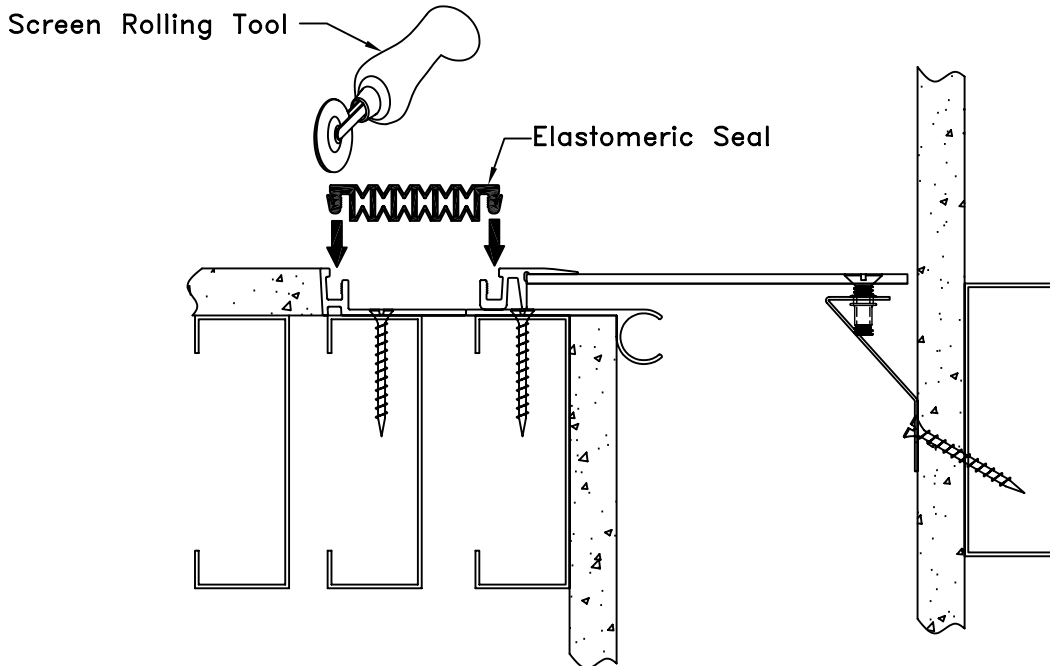

5

Position seal lug over extrusion cavity and insert lug into cavity using thumb pressure for initial insertion. Once elastomeric seal is inserted, run along top of lug with screen rolling tool to ensure complete lug insertion.

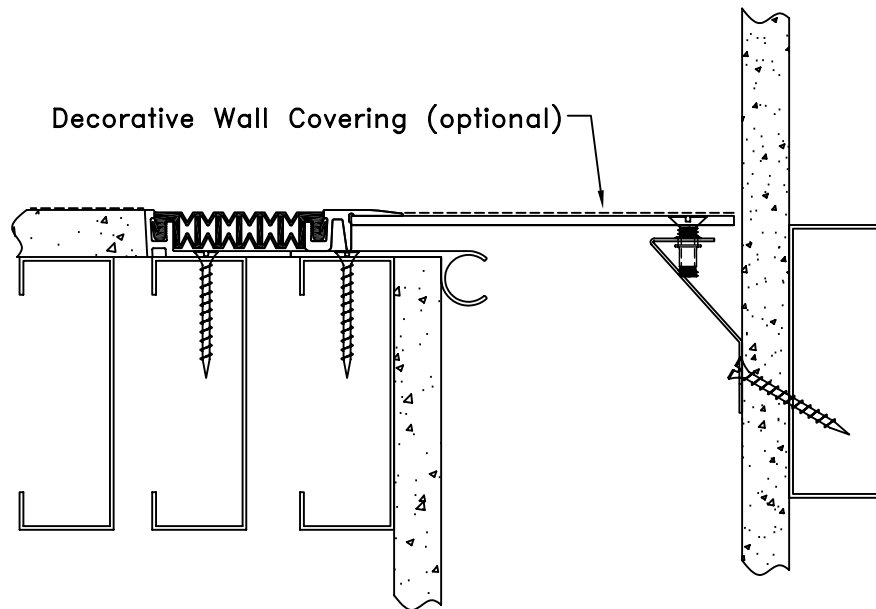

- 6** Optional: Wipe down aluminum slide plate to remove dust particles prior to applying decorative wall covering materials.
Caution: Contact Wall Covering Materials Manufacturer to discuss product application and procedure for proper installation. Screw heads should be covered with tape to avoid slot in screw head from telegraphing through wall covering.