

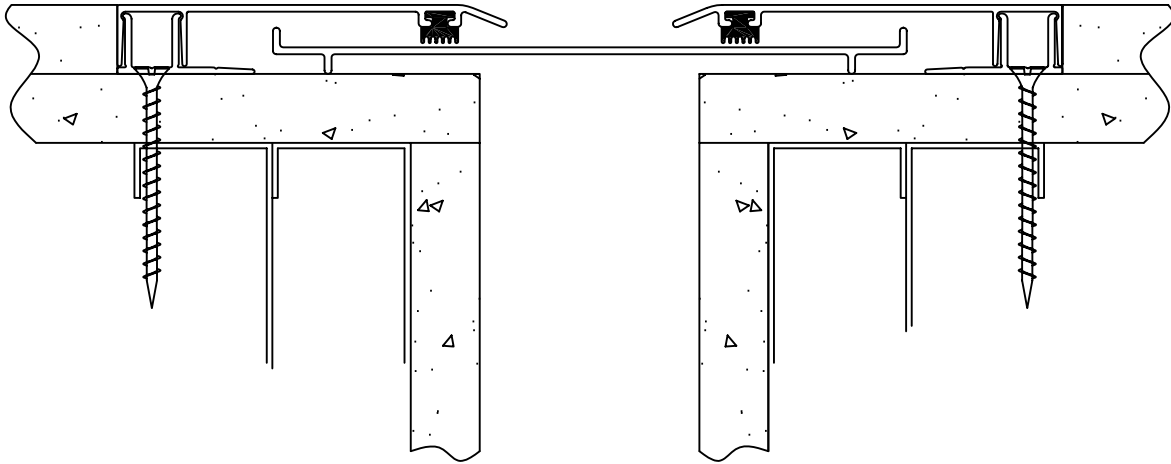

Erie Metal Specialties, Inc.
13311 Main Road
Akron, NY 14001

Phone: 716-542-3991
Website: www.eriemetal.com
E-Mail: sales@eriemetal.com



Glide Plate - Professional Series Model(s) EWCS 100-600 Vertical Expansion Control Systems

The following installation procedure is very important and must be fully understood prior to beginning any work. To ensure proper installation and performance of expansion joint system the following actions must be completed by the installing contractor. Failure to do so will affect product warranty.

- 1) Carefully read and understand installation procedure. Contact Technical Service Department for product assistance.
- 2) Inspect all shipments and materials for missing or damaged components and hardware. Contact Customer Service with order number and invoice for prompt assistance.
- 3) Inspect substrate or adjacent construction for acceptance before beginning work. Report unacceptable construction to the project manager for scheduled repair work.

Standard Components



PVC Gasket
P/n: 2838

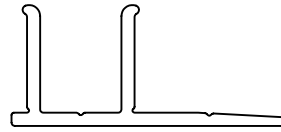

Base Extrusion
P/n: 11862

Components shown below vary in size depending on model of system

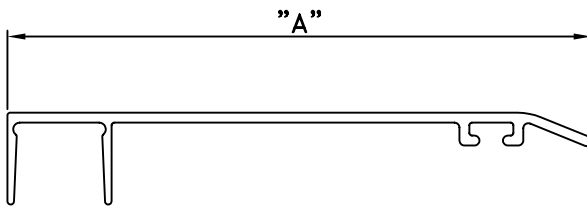

Anodized Aluminum Face Extrusion
(Refer to Chart for size and P/N's)

Model	"A"	P/N
EWCS-100	3 17/32"	11854
EWCS-200	3 17/32"	11854
EWCS-300	3 17/32"	11854
EWCS-400	5 1/32"	11860
EWCS-500	5 1/32"	11860
EWCS-600	5 1/32"	11860

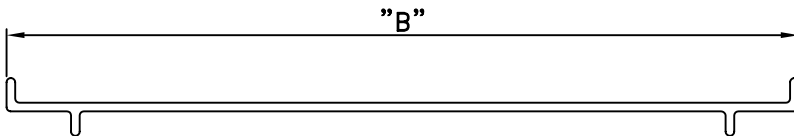

Anodized Aluminum Slide Plate
(Refer to Chart for size and P/N's)

Model	"B"	P/N
EWCS-100	5 3/4"	11855
EWCS-200	5 3/4"	11855
EWCS-300	5 3/4"	11855
EWCS-400	10 1/4"	11861
EWCS-500	10 1/4"	11861
EWCS-600	10 1/4"	11861

Installation Procedure

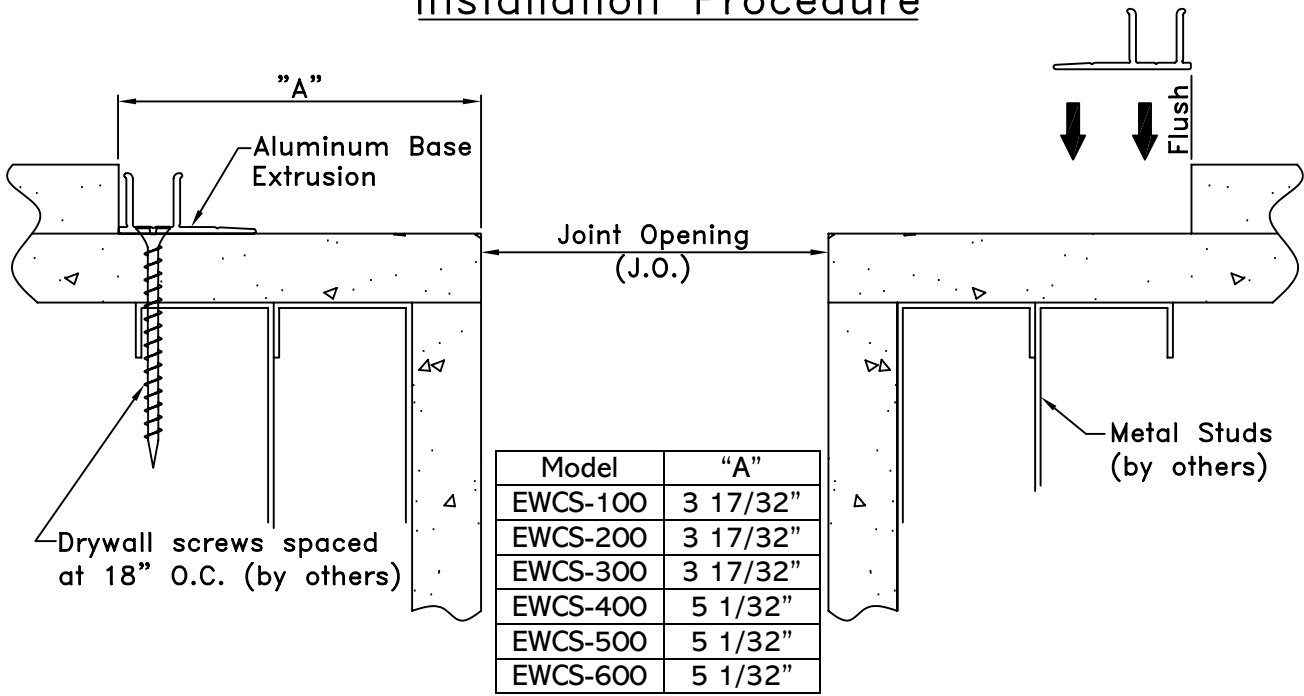

- 1 Position Aluminum Base Extrusion flush with Joint Opening. Field drill holes through the base extrusion and metal stud spaced at 18" O.C. Once the holes have been drilled, fasten base extrusion to wall with drywall screws (by others).

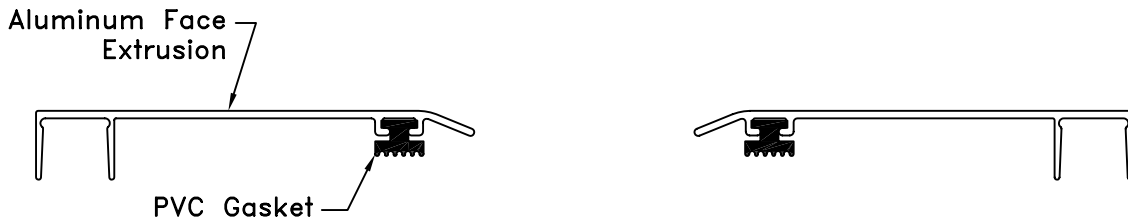

- 2 Cut PVC Gasket material to length and slide the gasket into groove on the Aluminum Face Extrusion.

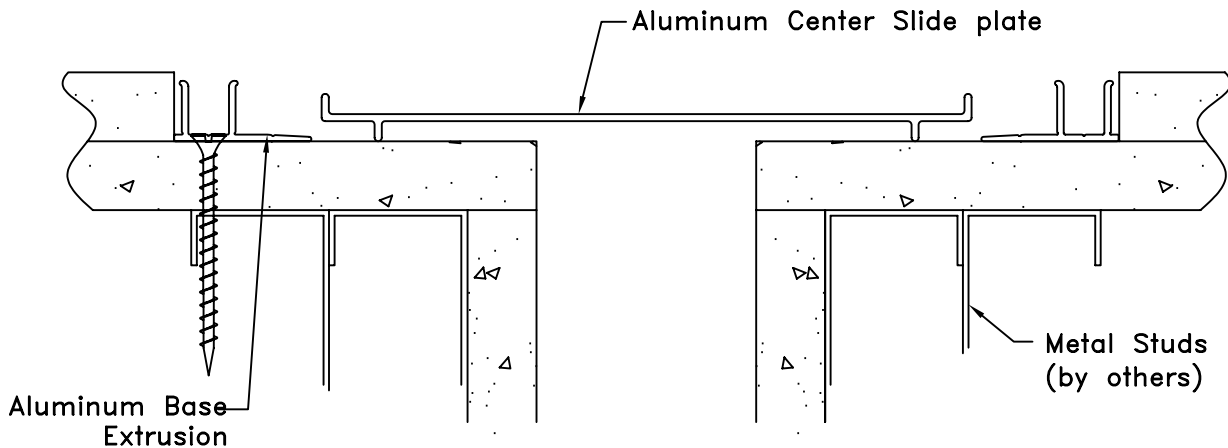

- 3 Position and center Aluminum Slide Plate against the base of the blockout.

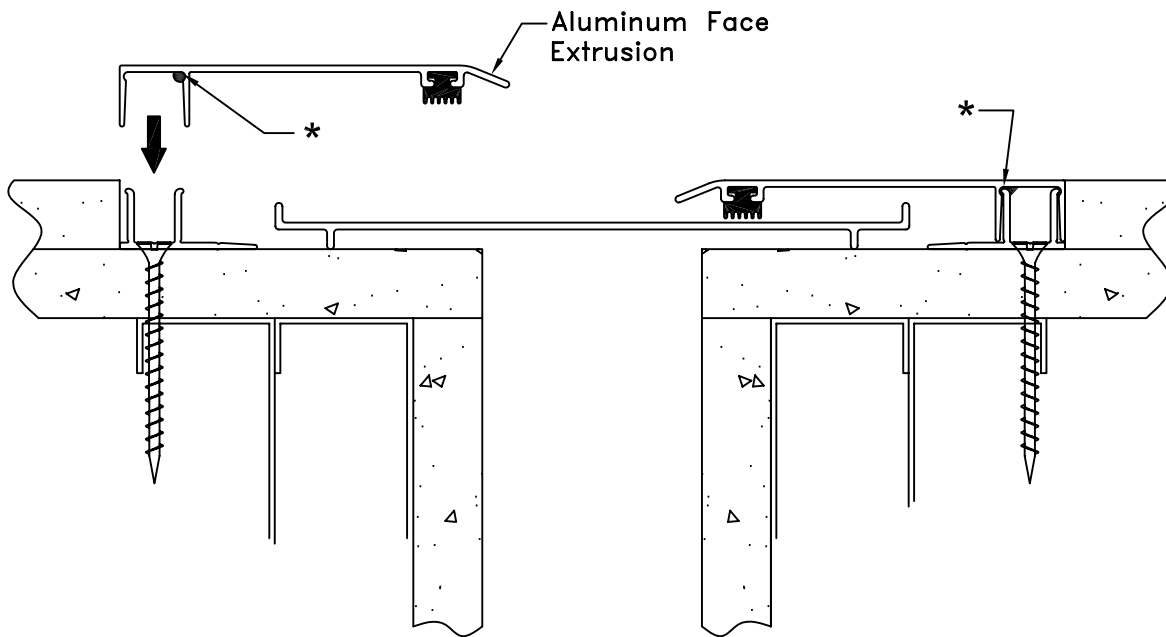

4

Apply Continuous Bead (start 1.2" from either end) of Dow Corning 795 Gray Sealant Adhesive where indicated.

Align Aluminum Face Extrusion with Gasket material in front of Base extrusion. Using the palm of your hand, gently tap Aluminum Face extrusion onto the Aluminum base extrusion. When installing, exercise care not to damage face extrusion.



Erie Metal Specialties, Inc.
13311 Main Road
Akron, NY 14001

Phone: 716-542-3991
Website: www.eriemetal.com
E-Mail: sales@eriemetal.com

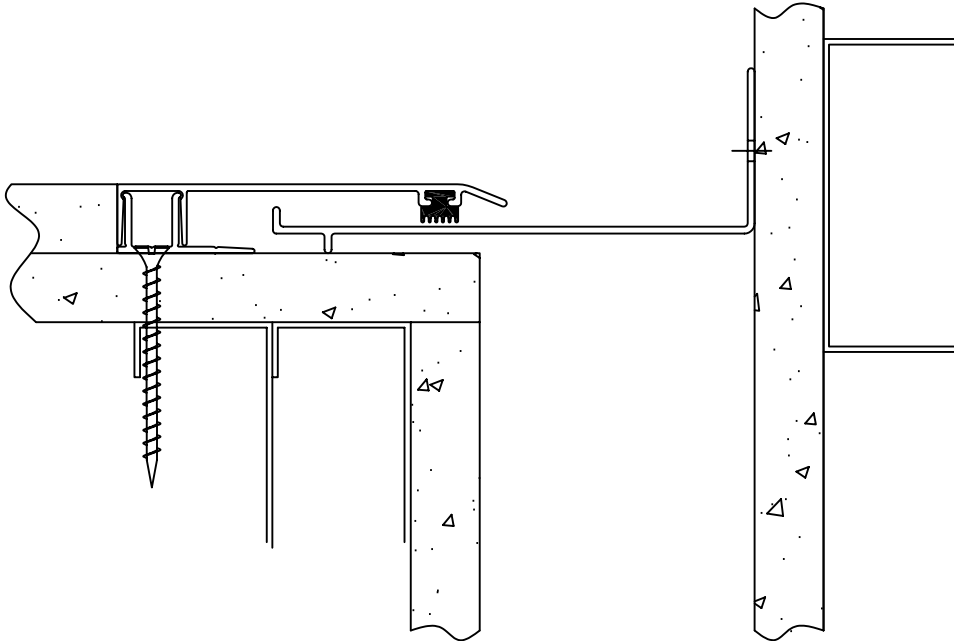

Glide Plate - Professional Series Model(s) EWCS 100W-600W Vertical Expansion Control Systems

The following installation procedure is very important and must be fully understood prior to beginning any work. To ensure proper installation and performance of expansion joint system the following actions must be completed by the installing contractor. Failure to do so will affect product warranty.

- 1) Carefully read and understand installation procedure. Contact Technical Service Department for product assistance.
- 2) Inspect all shipments and materials for missing or damaged components and hardware. Contact Customer Service with order number and invoice for prompt assistance.
- 3) Inspect substrate or adjacent construction for acceptance before beginning work. Report unacceptable construction to the project manager for scheduled repair work.

PN: N2Q242

Standard Components



#10 x 2" Lg Phillips
Head S.S. Tek Screw
P/n: 5832



PVC Gasket
P/n: 2838

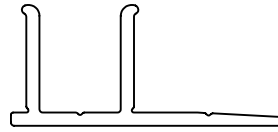

Base Extrusion
P/n: 11862

Components shown below vary in size depending on model of system

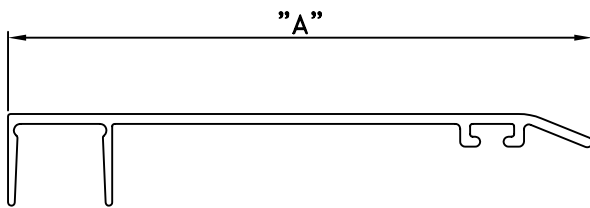

Anodized Aluminum Face Extrusion
(Refer to Chart for size and P/N's)

Model	"A"	P/N
EWCS-100W	4 17/32"	11856
EWCS-200W	4 17/32"	11856
EWCS-300W	4 17/32"	11856
EWCS-400W	6 1/32"	11863
EWCS-500W	6 1/32"	11863
EWCS-600W	6 1/32"	11863

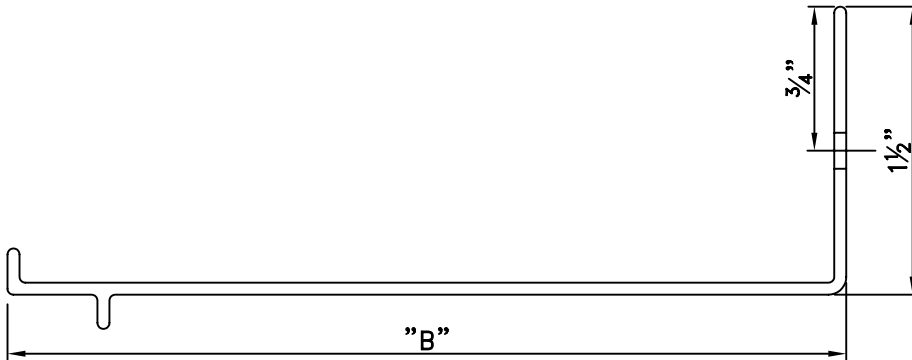

Anodized Aluminum Corner Slide Plate
(Refer to Chart for size and P/N's)

Model	"B"	P/N
EWCS-100W	4 3/8"	11857
EWCS-200W	4 3/8"	11857
EWCS-300W	4 3/8"	11857
EWCS-400W	8 1/8"	11864
EWCS-500W	8 1/8"	11864
EWCS-600W	8 1/8"	11864

DOW CORNING 795 GREY

Installation Procedure

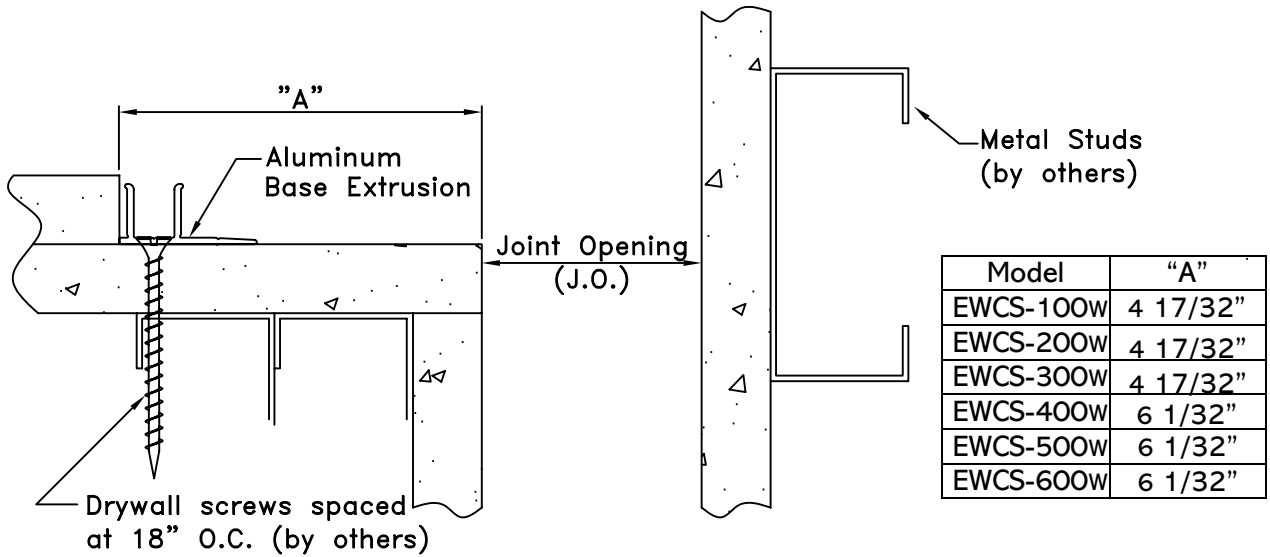

1

Position Aluminum Base Extrusion flush with Joint Opening. Field drill holes through the base extrusion and metal stud spaced at 18" O.C. Once the holes have been drilled, fasten base extrusion to wall with drywall screws (by others).

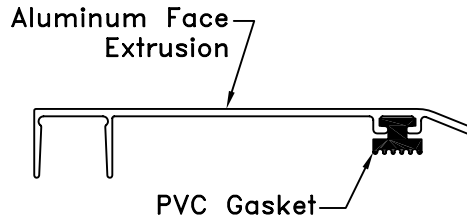

2

Cut PVC Gasket material to length and slide the gasket into groove on the Aluminum Face Extrusion.

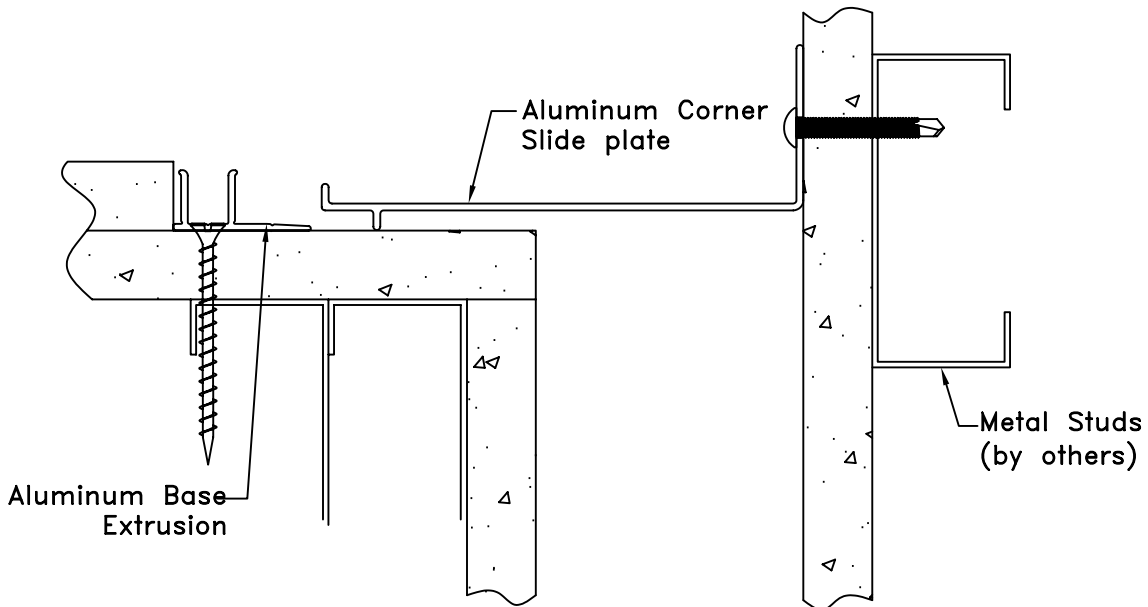

3

Position Aluminum Corner Slide Plate against the wall structure. After Corner slide plate location has been marked, fasten slide plate against wall with S.S. Tek Screw (P/n:5832).

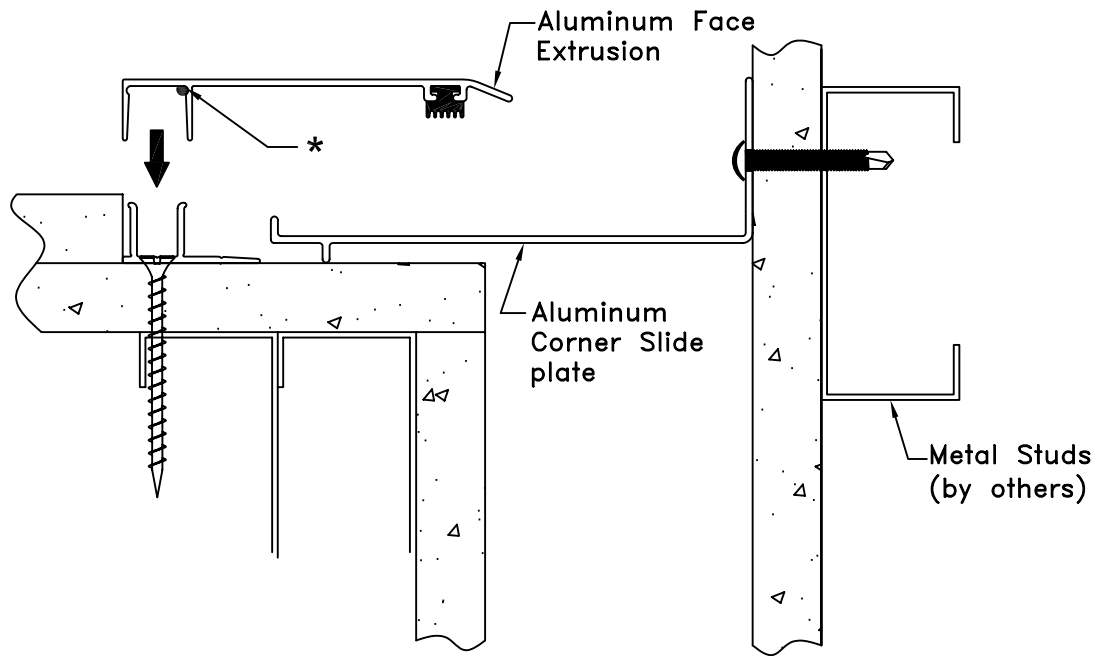

4

Apply Continuous Bead (start 1.2" from either end) of Dow Corning 795 Gray Sealant Adhesive where indicated.

Align Aluminum Face Extrusion with Gasket material in front of Base extrusion. Using the palm of your hand or rubber mallet, gently tap Aluminum Face extrusion onto the Aluminum base extrusion. When installing, exercise care not to damage face extrusion.