

EBWF
WALL TO WALL CONDITION

Model	Joint Opening (J.O.)						Total Movement		S.W.	
	at install		allow min.		allow max.				at install	
	inches	mm	inches	mm	inches	mm	inches	mm	inches	mm
EBWF-100	1	25	1/2	13	1 1/2	38	1	25	4 1/4	108
EBWF-200	2	51	1	25	3	76	2	51	5 3/4	146
EBWF-300	3	76	1 1/2	38	4 1/2	114	3	76	7 1/4	184
EBWF-400	4	102	2	50	6	152	4	102	8 1/4	210

NO.	Description	Date	By
<p>The information contained herein is the proprietary property of ERIE METAL SPECIALTIES, INC. No portion of it may be reproduced by any means or used in any form except for the purpose for which it was intended. All rights of design and invention are hereby reserved.</p>			



13311 Main Road • Akron • New York • 14001
 Phone: (716) 542-3991 • Fax: (716) 542-3996 • E-mail: sales@eriemetal.com

PROJECT:

TITLE:

Detailed by: BAF	Date: 10/21/17
Checked By: SLP	Date: 10/21/17
Scale: NTS	EMS Job #:
Sheet No.: 1 of 1	Drawing No.: EBWF-Series

Note:
For Rigidity, Double Stud
Recommended at
Expansion Joint opening

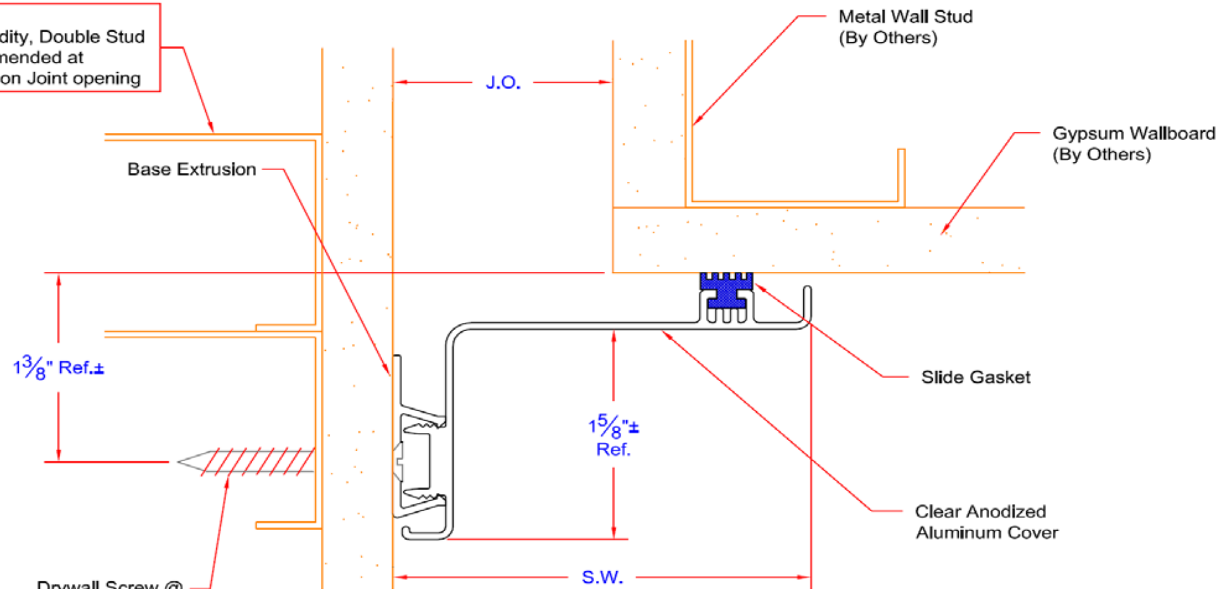

Typical Section
Wall To Wall Corner

EBWF-W
WALL TO WALL CORNER
CONDITION

Model	Joint Opening (J.O.)						Total Movement		S.W.	
	at install		allow min.		allow max.				at install	
	inches	mm	inches	mm	inches	mm	inches	mm	inches	mm
EBWF-100W	1	25	1/2	13	1 1/2	38	1	25	2 7/8	73
EBWF-200W	2	51	1	25	3	76	2	51	4 3/8	111
EBWF-300W	3	76	1 1/2	38	4 1/2	114	3	76	5 7/8	149
EBWF-400W	4	102	2	50	6	152	4	102	6 7/8	175

NO.	Description	Date	By
<p>The information contained herein is the proprietary property of ERIE METAL SPECIALTIES, INC. No portion of it may be reproduced by any means or used in any form except for the purpose for which it was intended. All rights of design and invention are hereby reserved.</p>			



13311 Main Road • Akron • New York • 14001
Phone: (716) 542-3991 • Fax: (716) 542-3996 • E-mail: sales@eriemetal.com

PROJECT:

TITLE:

Detailed by: BAF	Date: 10/21/17
Checked By: SLP	Date: 10/21/17
Scale: NTS	EMS Job #:
Sheet No.: 1 of 1	Drawing No.: EBWF-W-Series