

# CSIS-Series

## Description

The Compression Seal Integrated Sealant (CSIS) system is a factory cured strip of silicone sealant adhered to a rectangular polyurethane backer. The polyurethane backer is wider than the joint opening and the silicone is of a lesser width than the joint opening. The backer is compressed and placed into the joint, thus holding the cured silicone in a vertical position and leaving a recess on either side of the cured silicone and parallel substrate. A wet silicone sealant is caulked and tooled into the recess bridging the cured silicone and the interface of the parallel substrate.

The CSIS-Series foam seal is designed for sealing vertical expansion joint openings that measure 2" or greater.

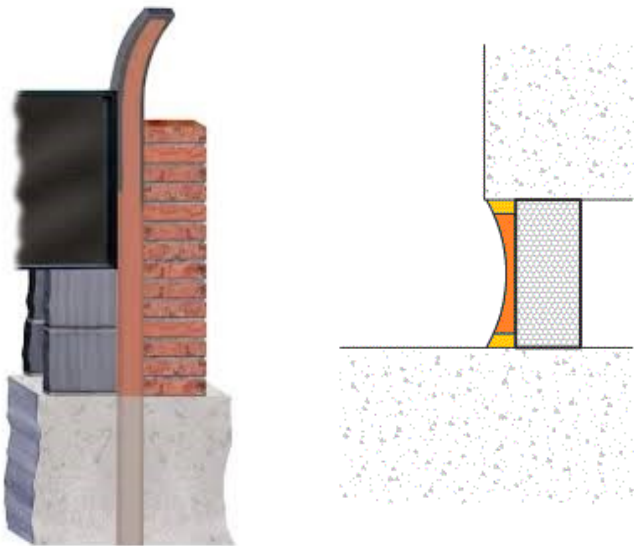

## Physical Properties

Properties	Result
Hardness (Shore A)	ASTM C661, 35-40
Tear Strength	ASTM C624, 6.9 k N/M
Elongation	ASTM D412, 250%
100% Modulus	ASTM D412, 1.03 MPa (150 psi)
Tensile Strength	ASTM C1135, Bead 3/8"x1/2" cured for 6 wks at 23°C and 50% R.H. pulled at 0.05"/min 0.69-0.90 MPa
Peel Strength (glass, aluminum, mortar)	ASTM C794, 2.28-2.63 kN/M (13-15 pli)
Movement	ASTM C719 25%
Movement	Bead of sealant cycled at 3mm (1/8") per hour after 28 days cure at 23°C and 50% R.H.

## Features and Benefits

- Long-lasting life due to not being affected by ozone or ultraviolet rays. Has excellent stability in regards to movement capability and modulus
- Movement capability of +/-50%
- Aesthetics allow for larger joint design which reduces stress on the bond line, increasing the chances of successful sealant installation
- Primerless adhesion to a variety of substrates including masonry and concrete. No staining
- Easy to install. No anchoring systems, mechanical fasteners, cutting of substrates or waiting for expansion to accrue.
- Caulking the reveals on each of the cured sealants makes it necessary to fill to full depth - no "cheating" on the amount of sealant placed
- Available in 16 standard colors. Custom colors available upon request

PRODUCT	MIN. WIDTH IN (MM)	MID-RANGE** IN (MM)	MAX. WIDTH IN (MM)	TOTAL MOVEMENT IN (MM)
CSIS-200	1.00" (25.4)	2.00" (50.8)	3.00" (76.2)	2.00" (50.8)
CSIS-250	1.25" (31.8)	2.50" (63.5)	3.75" (95.3)	2.50" (63.5)
CSIS-300	1.50" (38.1)	3.00" (76.2)	4.50" (114.3)	3.00" (76.2)
CSIS-350	1.75" (44.5)	3.50" (88.9)	5.25" (133.4)	3.50" (88.9)
CSIS-400	2.00" (50.8)	4.00" (101.6)	6.00" (152.4)	4.00" (101.6)
CSIS-450	2.25" (57.2)	4.50" (114.3)	6.75" (171.5)	4.50" (114.3)
CSIS-500	2.50" (63.5)	5.00" (127.0)	7.50" (190.5)	5.00" (127.0)
CSIS-550	2.75" (69.9)	5.50" (139.7)	8.25" (209.6)	5.50" (139.7)
CSIS-600	3.00" (76.2)	6.00" (152.4)	9.00" (228.6)	6.00" (152.4)
CSIS-650	3.25" (82.6)	6.50" (165.1)	9.75" (247.7)	6.50" (165.1)
CSIS-700	3.50" (88.9)	7.00" (177.8)	10.50" (266.7)	7.00" (177.8)