



# SUBSTITUTION REQUEST

(After the Bidding/Negotiating Phase)

Project: \_\_\_\_\_ Substitution Request Number: \_\_\_\_\_  
 \_\_\_\_\_  
 From: \_\_\_\_\_  
 To: \_\_\_\_\_ Date: \_\_\_\_\_  
 \_\_\_\_\_  
 A/E Project Number: \_\_\_\_\_  
 Re: \_\_\_\_\_ Contract For: \_\_\_\_\_

Specification Title: \_\_\_\_\_ Description: \_\_\_\_\_  
 Section: \_\_\_\_\_ Page: \_\_\_\_\_ Article/Paragraph: \_\_\_\_\_

Proposed Substitution: \_\_\_\_\_  
 Manufacturer: \_\_\_\_\_ Phone: \_\_\_\_\_  
 Address: \_\_\_\_\_  
 Trade Name: \_\_\_\_\_ Model No.: \_\_\_\_\_  
 Installer: \_\_\_\_\_ Phone: \_\_\_\_\_  
 Address: \_\_\_\_\_

History:  New product  1-4 years old  5-10 years old  More than 10 years old

Differences between proposed substitution and specified product: \_\_\_\_\_  
 \_\_\_\_\_  
 \_\_\_\_\_

Point-by-point comparative data attached — REQUIRED BY A/E

Reason for not providing specified item: \_\_\_\_\_  
 \_\_\_\_\_

### Similar Installation:

Project: \_\_\_\_\_ Architect: \_\_\_\_\_  
 Address: \_\_\_\_\_ Owner: \_\_\_\_\_  
 \_\_\_\_\_ Date Installed: \_\_\_\_\_

Proposed substitution affects other parts of Work:  No  Yes; explain \_\_\_\_\_  
 \_\_\_\_\_

Savings to Owner for accepting substitution: \_\_\_\_\_ (\$ \_\_\_\_\_).

Proposed substitution changes Contract Time:  No  Yes [Add] [Deduct] \_\_\_\_\_ days.

Supporting Data Attached:  Drawings  Product Data  Samples  Tests  Reports  \_\_\_\_\_

# SUBSTITUTION REQUEST

(After the Bidding/Negotiating Phase — Continued)

---

The Undersigned certifies:

- Proposed substitution has been fully investigated and determined to be equal or superior in all respects to specified product.
  - Same warranty will be furnished for proposed substitution as for specified product.
  - Same maintenance service and source of replacement parts, as applicable, is available.
  - Proposed substitution will have no adverse effect on other trades and will not affect or delay progress schedule.
  - Cost data as stated above is complete. Claims for additional costs related to accepted substitution which may subsequently become apparent are to be waived.
  - Proposed substitution does not affect dimensions and functional clearances.
  - Payment will be made for changes to building design, including A/E design, detailing, and construction costs caused by the substitution.
  - Coordination, installation, and changes in the Work as necessary for accepted substitution will be complete in all respects.
- 

Submitted by: \_\_\_\_\_

Signed by: \_\_\_\_\_

Firm: \_\_\_\_\_

Address: \_\_\_\_\_

Telephone: \_\_\_\_\_

Attachments:

---

## A/E's REVIEW AND ACTION

- Substitution approved - Make submittals in accordance with Specification Section 01 25 00 Substitution Procedures.
- Substitution approved as noted - Make submittals in accordance with Specification Section 01 25 00 Substitution Procedures.
- Substitution rejected - Use specified materials.
- Substitution Request received too late - Use specified materials.

Signed by: \_\_\_\_\_ Date: \_\_\_\_\_

---

Additional Comments:  Contractor  Subcontractor  Supplier  Manufacturer  A/E  
 Other:

# ESA/EDA Series Flooring System

## Interior Joints (Floor)

The Single Wing and Double Wing Flooring Infill System is designed to cover thermal expansion joint openings. Constructed of aluminum and designed to integrate with carpet, tile and VCT flooring, this system provides a minimal 1-1/2 inch sight line.

### FEATURES

**COORDINATE WITH FLOORING** Seamless integration with existing VCT, carpet and tile flooring.

**DOUBLE WING OPTION** Add a double sight line to coordinate with a matching wall system.

**ADA COMPLIANT** This system is not a trip hazard as the no bump design provides a finished flush floor transition.

### DETAILS

**MATERIAL** 6063-T6 Aluminum

**FINISH** Mill

#### MOVEMENT

- Thermal: Horizontal

**MOUNTING** Surface

**JOINT SIZE** Up to 2 inches

**LENGTH** 10 Linear Feet

**LOAD** Pedestrian and Light Cart

**INSTALLATION** Floor

**OPTIONS** Moisture Barrier, Fire Barrier

### MODELS

#### SINGLE WING

MODEL	JOINT SIZE AT MEAN T°F	EXPOSED SIGHT-LINE	FLOOR INFILL HEIGHT	TOTAL MOVEMENT
ESA150-125	2" (51mm)	1.5" (38mm)	0.125" (3mm)	1" (25mm)
ESA150-250	2" (51mm)	1.5" (38mm)	0.25" (6mm)	1" (25mm)
ESA150-375	2" (51mm)	1.5" (38mm)	0.375" (10mm)	1" (25mm)

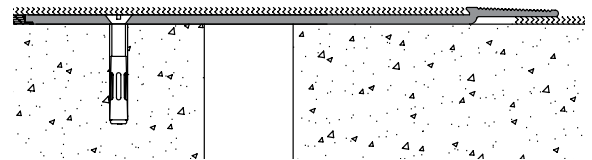

Single Wing Floor-to-Floor

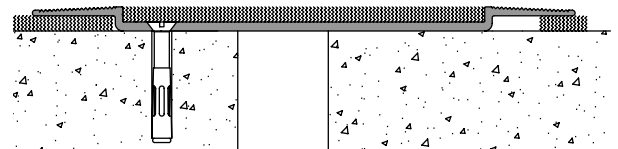

Double Wing Floor-to-Floor

#### DOUBLE WING

MODEL	JOINT SIZE AT MEAN T°F	EXPOSED SIGHT-LINE	FLOOR INFILL HEIGHT	TOTAL MOVEMENT
EDA150-125	2" (51mm)	4" (102mm)	0.125" (3mm)	1" (25mm)
EDA150-250	2" (51mm)	4" (102mm)	0.25" (6mm)	1" (25mm)
EDA150-375	2" (51mm)	4" (102mm)	0.375" (10mm)	1" (25mm)



Erie Metal Specialties, Inc.  
13311 Main Road  
Akron, NY 14001

Phone: 716-542-3991  
Website: [www.eriemetal.com](http://www.eriemetal.com)  
E-Mail: [sales@eriemetal.com](mailto:sales@eriemetal.com)



Erie Metal Specialties, Inc.  
13311 Main Road  
Akron, NY 14001

Phone: 716-542-3991  
Website: [www.eriemetal.com](http://www.eriemetal.com)  
E-Mail: [sales@eriemetal.com](mailto:sales@eriemetal.com)

## ESA150 Series Expansion Joint Cover – Installation Instructions

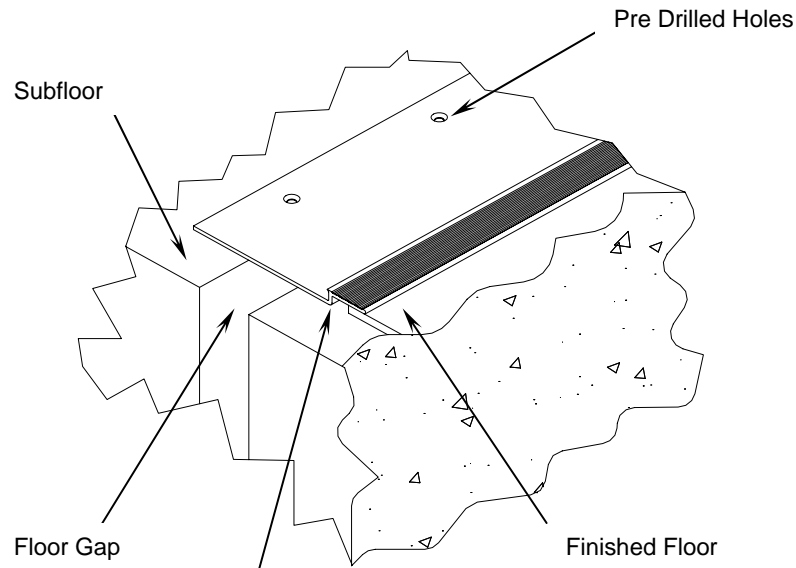

DIAGRAM 1

REQUIRED:  
INSTALL WITH OPEN SPACE TO  
ALLOW FOR FLOOR MOVEMENT

### EMS Supplies These Items Along with Expansion Joint Covers:

1. Sleeve anchors, 1/4
2. Fire barrier if required

### Materials Needed by Installer:

1. Electric drill
2. Tape measure or ruler
3. Broom and dust pan or vacuum
4. Chop saw to cut joints to length
5. 1/4" masonry bit
6. Flash patch and utensils

### Installation Instructions

1. Insure that the floor is smooth. High spots should be ground down and low spots filled in. Make sure floor is clean by sweeping and/or vacuuming floor.
2. Cut and fit expansion joints to required length, if installing more than 1 piece lay out entire run to insure proper alignment. Make sure that the anchors are at least 1 1/4" from floor gap wall.
3. Drill end holes first, this insures that the expansion joint will not move and alignment with other joints is obtained. Expansions joints are supplied with predrilled holes (see diagram). Drill holes to a depth of 2.50 inches, using correct drill bit, 1/4 concrete drill bit.
4. Insert the assembled anchor into hole so the head of anchor is flush with top surface of expansion joint. Expand the anchor by tightening the head 2 to 3 turns.
5. Once anchors are in the end holes, drill remaining holes and install anchors.
6. Flash patch on anchored side and feather back 3-6 inches to assure a smooth transition.
7. Cut in floor covering; make sure it abuts tightly to the edge of the wing on the fixed portion of expansion joint. The floor covering should extend only halfway under the unsecured wing (note open space in diagram).



Erie Metal Specialties, Inc.  
13311 Main Road  
Akron, NY 14001  
Phone: 716-542-3991  
Fax: 716-542-3996  
E-mail: [sales@eriemetal.com](mailto:sales@eriemetal.com)  
Website: [www.eriemetal.com](http://www.eriemetal.com)

## SPECIFICATION

### Section 07 95 13

**Erie Metal Specialties, Interior Architectural Systems**

**Model(s) “ESA150”**

### **Horizontal Expansion Control Systems**

#### **PART 1 - GENERAL**

##### 1.01 Work Included

- A. The work shall consist of furnishing and installing expansion joints in accordance with the details shown on the plans and the requirements of the specifications. The joints are proprietary designs utilizing preformed metal components and anchors.
- B. Related Work
  - Cast-in-place concrete
  - Miscellaneous and ornamental metals
  - Flashing and sheet metal

##### 1.02 Submittals

- A. Template Drawings- Submit typical expansion joint cross-section(s) indicating pertinent dimensioning, general construction, component connections, and anchorage methods.

##### 1.03 Product Delivery, Storage and Handling

- A. Deliver products in each manufacturer's original, intact, labeled containers and store under cover in a dry location until installed. Store off the ground, protect from weather and construction activities.

##### 1.04 Acceptable Manufacturer

- A. All joints shall be supplied by; Erie Metal Specialties, Inc. • 13311 Main Road • Akron • New York • 14001 • Phone (716) 542-3991 • Fax (716) 542-3996 • [sales@eriemetal.com](mailto:sales@eriemetal.com) • [www.eriemetal.com](http://www.eriemetal.com) .
- B. Alternate manufacturers and their products will be considered, provided they meet the design concept and are produced of materials that are equal to or superior to those specified.



Erie Metal Specialties, Inc.  
13311 Main Road  
Akron, NY 14001  
Phone: 716-542-3991  
Fax: 716-542-3996  
E-mail: [sales@eriemetal.com](mailto:sales@eriemetal.com)  
Website: [www.eriemetal.com](http://www.eriemetal.com)

- C. Any proposed alternate systems must be submitted and receive approval 21 days prior to the bid. All post bid submittals will not be considered. This submission shall be in accordance with MATERIALS AND SUBSTITUTIONS.

- Any manufacturer wishing to submit for prior approval must provide the following:

A working 6" sample of the proposed system with a letter describing how system is considered superior to the specified system.

A project proposal drawing that illustrates the recommended alternate system installed in the floor construction that is specific to the project. Typical catalog cut sections will not be considered.

A Verifiable list of prior installations showing prior and successful experience with the proposed Systems.

Any substitution products not adhering to all specification requirements within, will not be considered.

#### 1.05 Quality Assurance

- A. Manufacturer: Shall have a minimum ten (10) years experience specializing in the design and manufacture of Architectural Expansion Control Systems.

## **PART 2 - PRODUCT**

#### 2.01 General

- A. Provide floor joint cover consisting of metal profiles that utilize various metal finishes designed of width and thickness required to satisfy projects movement and loading requirements. Secure cover plate to concrete floor slab by utilizing manufacturer's recommended anchoring system.

Furnish Erie Metal Specialties, Model "ESA150" meeting ADA guidelines for interior joint locations as manufactured by Erie Metal Specialties and as indicated on drawings. Select Model based on requirements.

#### 2.02 Components and Materials

- A. Aluminum Shapes - Material to conform to ASTM B209, alloy 6061-T6 (flush floor).
- B. Moisture Barrier (optional) - Shall be a fabric reinforced tear resistant clear vinyl sheet material. minimum thickness shall be .026".
- C. Anchorage - Provide minimum 1/4" diameter concrete expansion anchor at maximum 18" o.c. spacing to secure aluminum cover to floor slab.



Erie Metal Specialties, Inc.  
13311 Main Road  
Akron, NY 14001  
Phone: 716-542-3991  
Fax: 716-542-3996  
E-mail: [sales@eriemetal.com](mailto:sales@eriemetal.com)  
Website: [www.eriemetal.com](http://www.eriemetal.com)

- D. Accessories - Provide necessary and related parts, and fasteners required for complete installation.
- E. Fire Barrier Assembly - Designed for indicated or required dynamic structural movement without material degradation or fatigue. Tested in maximum joint width conditions with a field splice as a component of the expansion joint cover in accordance with ASTM E-119 at full rated period by a nationally recognized testing and inspecting organization.
- F. Concrete Slab Repair (recommended) - Utilize single component rapid strength repair mortar meeting the following data requirements.

Compressive strength, psi (ASTM C 109)

2 hours	1,500
24 hours	4,500
7 days	8,000
28 days	9,000

2.03 Fabrication

- A. Extrusions to be shipped in standard 10 ft. lengths and shall be cut to length on jobsite where required. Profiles shall be miter cut in the field to conform to directional changes unless otherwise contracted with expansion joint manufacturer.
- B. Anchor holes for corner condition wall mount profile shall be countersunk and field drilled by installing contractor at 12" o.c.
- C. Fire Barriers - Ship manufacturer's standard assembly for the required hourly rating. Fire barrier shall be miter cut in the field to accommodate changes in direction.

2.04 Finishes

- A. All Profiles
  - 1. Standard - Aluminum extrusions shall be supplied in mill finish.

**PART 3 - EXECUTION**

3.01 Installation

- A. Verify that project conditions are suitable for proper installation of system.
- B. Protect all expansion joint component parts from damage during installation and placement of finish floor materials and thereafter until completion of structure.
- C. Expansion joint systems shall be installed in strict accordance with the manufacturer's typical details and instructions along with the advice of their qualified representative.



Erie Metal Specialties, Inc.  
13311 Main Road  
Akron, NY 14001  
Phone: 716-542-3991  
Fax: 716-542-3996  
E-mail: [sales@eriemetal.com](mailto:sales@eriemetal.com)  
Website: [www.eriemetal.com](http://www.eriemetal.com)

### 3.02 Clean and Inspect

- A. Upon completing installation the contractor shall clean all exposed metal surfaces with a suitable cleaner that will not harm or attack the finish. Contact manufacturer should questions arise regarding suitability of any cleaner type prior to its use.



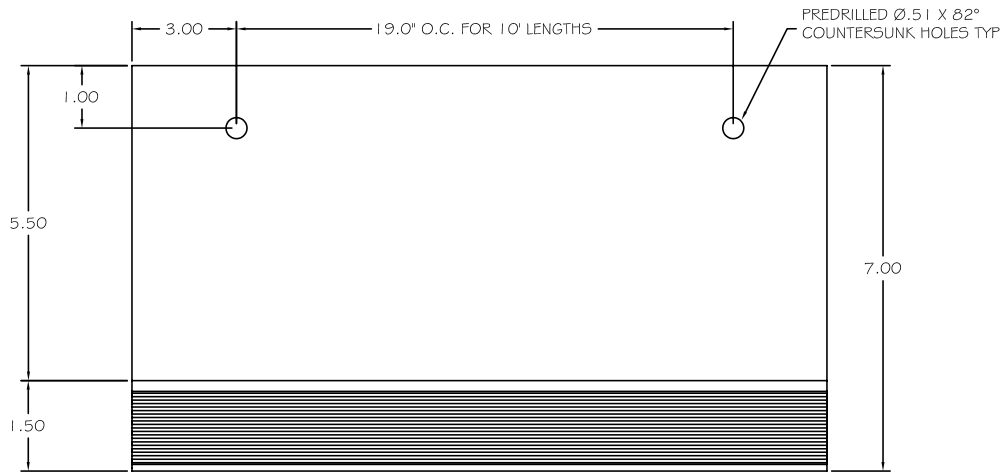

PLAN VIEW  
(NOT TO SCALE)

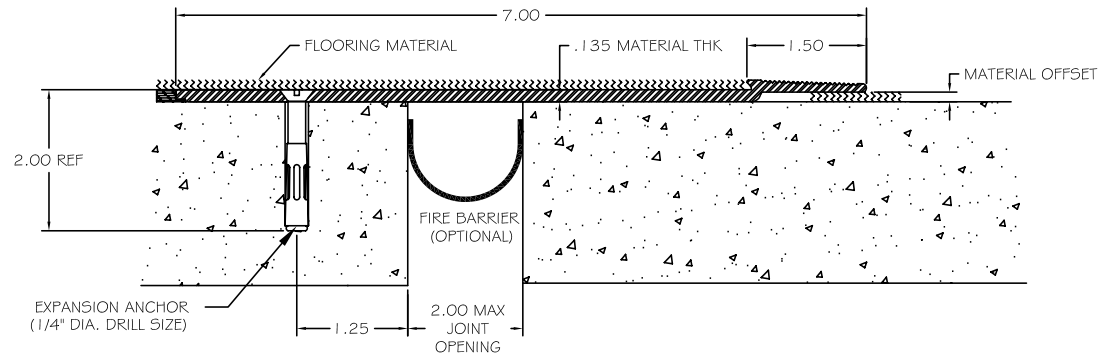

SURFACE CROSS SECTION  
(NOT TO SCALE)

**SPECIFICATIONS**

- 6063-T6 ALUMINUM
- MILL FINISH
- SUPPLIED WITH EXPANSION ANCHORS
- STANDARD LENGTH=10' / SECTION

PART NUMBER	MATERIAL OFFSET
ESA150-125	.125
ESA150-250	.250
ESA150-375	.375

MAX LOAD @ 2" JOINT OPENING	
CONCENTRATED	100#
UNIFORM	70 PSI

NO.	Description	Date	By

The information contained herein is the proprietary property of ERIE METAL SPECIALTIES, INC. No portion of it may be reproduced by any means or used in any form except for the purpose for which it was intended. All rights of design and invention are hereby reserved.



13311 Main Road • Akron • New York • 14001  
 Phone: (716) 542-3991 • Fax: (716) 542-3996 • E-mail: sales@eriemetal.com

**PROJECT:**

**TITLE:**

Detailed by: BAF	Date: 10/21/17
Checked By: SLP	Date: 10/21/17
Scale: NTS	EMS Job #:
Sheet No.: 1 of 1	Drawing No.: