

**CR-SERIES**  
Slab to Slab Condition

PRODUCT	"A" Min. Width IN (MM)	"A" Mid Range IN (MM)	"A" Max. Width IN (MM)	Total Movement IN (MM)
CR-200	0.75" (19)	1.38" (35)	2.00" (51)	1.25" (32)
CR-250	0.75" (19)	1.63" (41)	2.50" (64)	1.75" (44)
CR-300	1.00" (32)	2.00" (57)	3.00" (83)	2.00" (51)
CR-400	1.50" (38)	2.75" (70)	4.00" (102)	2.50" (64)
CR-500	1.75" (44)	3.38" (86)	5.00" (127)	3.25" (83)
CR-600	2.12" (54)	4.06" (103)	6.00" (152)	3.88" (99)

NO.	Description	Date	By

The information contained herein is the proprietary property of ERIE METAL SPECIALTIES, INC. No portion of it may be reproduced by any means or used in any form except for the purpose for which it was intended. All rights of design and invention are hereby reserved.



13311 Main Road \* Akron \* New York \* 14001  
Phone: (716) 542-3991 \* Fax: (716) 542-3996 \* E-mail: sales@eriemetal.com

PROJECT: N/A

TITLE: CR-SERIES Slab to Slab Condition

Detailed by: BAF	Date: 07/20/16
Checked by: SLP	Date: 07/22/16
Scale: NTS	EMS Job #: N/A
Sheet No.: 1 of 1	Drawing No.: CR-1

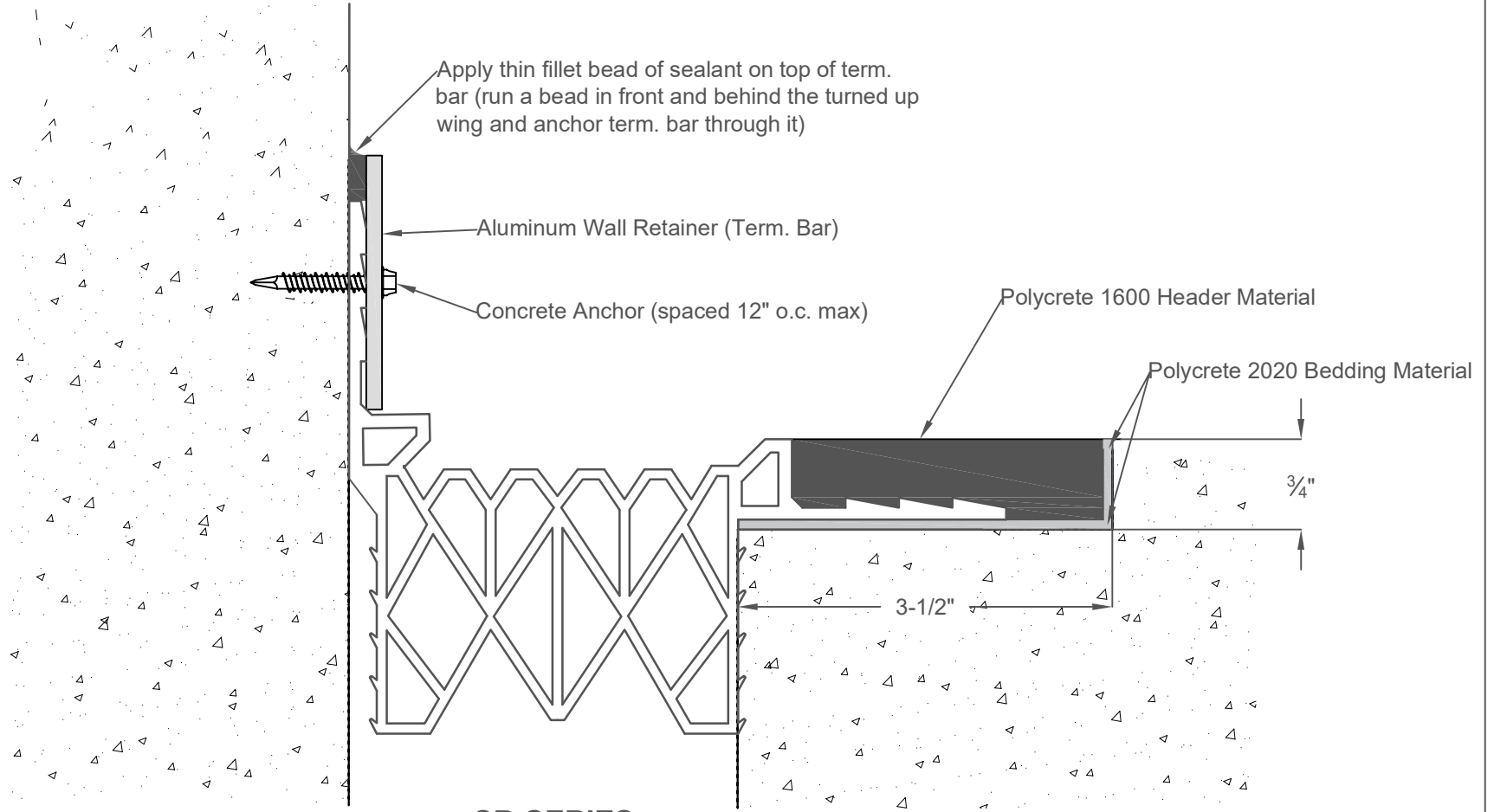

**CR-SERIES**  
Slab to Wall Condition



**ERIE METAL  
SPECIALTIES**

13311 Main Road \* Akron \* New York \* 14001  
Phone: (716) 542-3991 \* Fax: (716) 542-3996 \* E-mail: sales@eriemetal.com

PROJECT: N/A

TITLE: CR-Series Slab to Wall Condition

Detailed by: BAF	Date: 5-10-15
Checked by: SLP	Date: 5-10-15
Scale: NTS	EMS Job #: N/A
Sheet No.: 1-1	Drawing No.: CR-FW

NO.	Description	Date	By

The information contained herein is the proprietary property of ERIE METAL SPECIALTIES, INC. No portion of it may be reproduced by any means or used in any form except for the purpose for which it was intended. All rights of design and invention are hereby reserved.