

Model	Joint Opening (J.O.)						Total Movement		S.W.	
	at install		allow min.		allow max.		inches	mm	at install	
	inches	mm	inches	mm	inches	mm			inches	mm
ETMM-200	2	51	1	25	5 1/4	133	4 1/4	108	7 3/4	197
ETMM-400	4	102	1	25	7 1/4	184	6 1/4	159	9 3/4	248
ETMM-600	6	152	1	25	9 1/4	235	8 1/4	210	11 3/4	298

**Note: J.O. minimum and maximum values are after thermal movement occurs.**

NO.			

The information contained herein is the proprietary property of ERIE METAL SPECIALTIES, INC. No portion of it may be reproduced by any means or used in any form except for the purpose for which it was intended. All rights of design and invention are hereby reserved.



13311 Main Road • Akron • New York • 14001  
 Phone: (716) 542-3991 • Fax: (716) 542-3996 • E-mail: sales@eriemetal.com

**PROJECT:**

**TITLE:**

Detailed by: BAF	Date: 10/21/17
Checked By: SLP	Date: 10/21/17
Scale: NTS	EMS Job #:
Sheet No.: 1 of 1	Drawing No.:

Design Features

- Aesthetically attractive
- Slide plate recess accepts finish inlay materials
- Gasket provides flush finish and installation
- Easily replaceable flat gasket
- No preformed blockouts required - most applications
- Simple installation - fewer components
- Corridor wrap sightlines - utilize for floor and wall applications
- Low height system 5/8"
- Multi-directional movement
- Complies with ADA guidelines

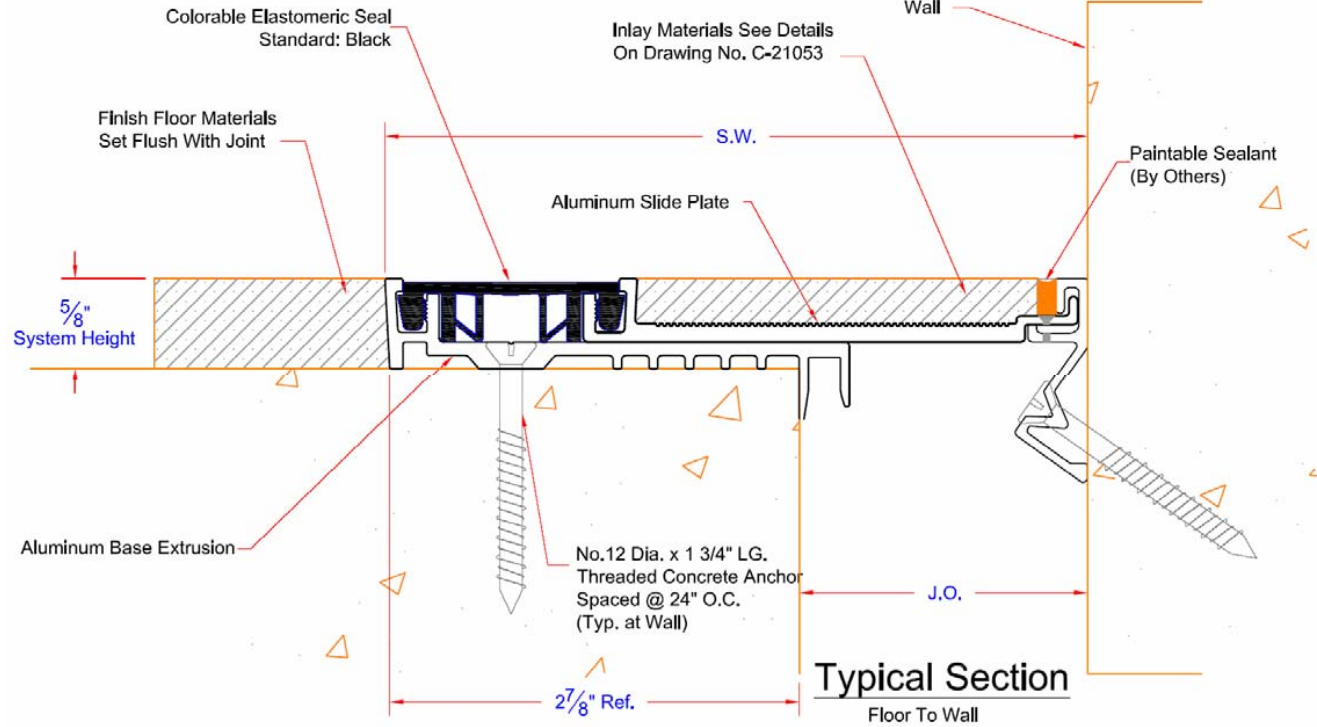

Model	Joint Opening (J.O.)						Total Movement		S.W.	
	at install		allow min.		allow max.		inches	mm	at install	
	inches	mm	inches	mm	inches	mm			inches	mm
ETMM-200W	2	51	1 1/8"	29	3 5/8	92	2 1/2	64	4 7/8	124
ETMM-400W	4	102	1 1/8"	29	5 5/8	143	4 1/2	114	6 7/8	175
ETMM-600W	6	152	1 1/8"	29	7 5/8	194	6 1/2	165	8 7/8	225

Note: J.O. minimum and maximum values are after thermal movement occurs.

NO.	Description	Date	By
The information contained herein is the proprietary property of ERIE METAL SPECIALTIES, INC. No portion of it may be reproduced by any means or used in any form except for the purpose for which it was intended. All rights of design and invention are hereby reserved.			



13311 Main Road • Akron • New York • 14001  
 Phone: (716) 542-3991 • Fax: (716) 542-3996 • E-mail: sales@eriemetal.com

PROJECT:

TITLE:

Detailed by: BAF	Date: 10/21/17
Checked By: SLP	Date: 10/21/17
Scale: NTS	EMS Job #:
Sheet No.: 1 of 1	Drawing No.: