

# ELCD Series - Drywall Bead Application

## FEATURES

**COMPLEMENTARY SEAL COLORS** Available in four elastomeric colors: beige, white, gray or black.

**MAXIMUM MOVEMENT** "V" seal design allows for maximum thermal and seismic movement

**DRYWALL BEAD FLANGE** Designed for drywall applications with punched holes for easy mounting. Drywall mud is floated overtop of flange and easily painted leaving only the seal exposed.

## DETAILS

### MATERIAL

6063-T6 Aluminum, Meets ASTM B209

**FINISH** Mill

### MOVEMENT

- Thermal: Horizontal
- Seismic: Lateral Shaer

**MOUNTING** Flush with Drywall Bead

**JOINT SIZE** 2 to 6 inches

**SEAL LENGTH** Continuous

**APPLICATION** Interior

**INSTALLATION** Wall or Ceiling

**OPTIONS** Additional size and material options available upon request.

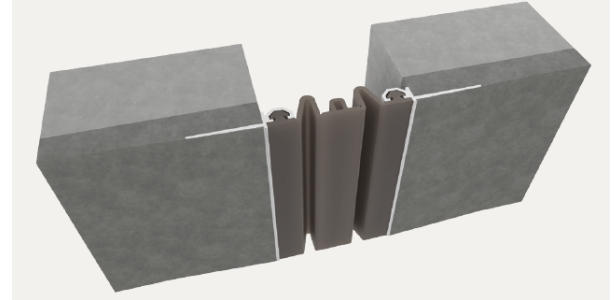

### WALL/CEILING-TO-WALL/CEILING

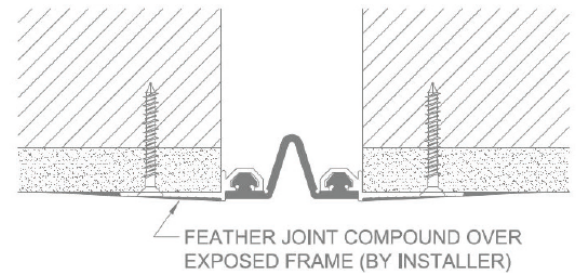

### WALL/CEILING-TO-CORNER

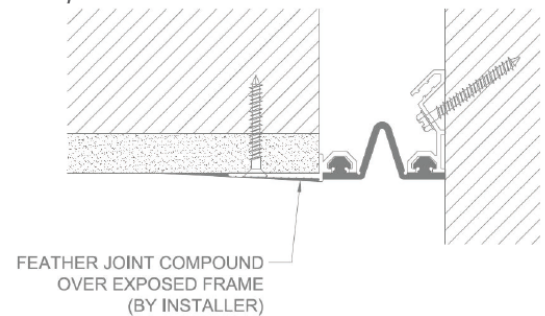

## SEAL COLORS



Beige

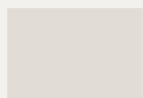

White



Gray



Black

## MODELS

MODEL	APPLICATION	JOINT SIZE AT MEAN T°F	EXPOSED SIGHT LINE	TOTAL MOVEMENT
ELCD-200	Wall/Ceiling to Wall/Ceiling	2" (51mm)	2" (51mm)	2" (51mm)
ELCD-300	Wall/Ceiling to Wall/Ceiling	3" (76mm)	3" (76mm)	3" (76mm)
ELCD-400	Wall/Ceiling to Wall/Ceiling	4" (102mm)	4" (102mm)	4" (102mm)
ELCD-500	Wall/Ceiling to Wall/Ceiling	5" (127mm)	5" (127mm)	5" (127mm)
ELCD-600	Wall/Ceiling to Wall/Ceiling	6" (152mm)	6" (152mm)	6" (152mm)
ELCD-200W	Wall/Ceiling to Corner	2" (51mm)	2" (51mm)	2" (51mm)
ELCD-300W	Wall/Ceiling to Corner	3" (76mm)	3" (76mm)	3" (76mm)
ELCD-400W	Wall/Ceiling to Corner	4" (102mm)	4" (102mm)	4" (102mm)
ELCD-500W	Wall/Ceiling to Corner	5" (127mm)	5" (127mm)	5" (127mm)
ELCD-600W	Wall/Ceiling to Corner	6" (152mm)	6" (152mm)	6" (152mm)



Erie Metal Specialties, Inc.  
13311 Main Road  
Akron, NY 14001

Phone: 716-542-3991  
Website: [www.eriametal.com](http://www.eriametal.com)  
E-Mail: [sales@eriametal.com](mailto:sales@eriametal.com)