

SEAL COLOR SELECTOR			
BLACK	_____	WHITE	_____
BEIGE	_____	GRAY	_____

***INTERIOR WALL & CLG. FLAT/CORNER DRYWALL SYS.***  
 MOVEMENT: +/- 50% NOMINAL JOINT WIDTH  
 STOCK LENGTHS: ALUMINUM FRAMES: 10'  
 SEAL: CONTINUOUS

PRODUCT	Application	Joint Size @ Mean T°F	Exposed Site line: IN (MM)	Total Movement IN (MM)
ELCD-200	Wall/Ceiling	2.00" (51)	2.00" (51)	2.00" (51)
ELCD-200W	Wall/Ceiling Corner	2.00" (51)	2.00" (51)	2.00" (51)

NO.	Description	Date	By
<small>The information contained herein is the proprietary property of ERIE METAL SPECIALTIES, INC. No portion of it may be reproduced by any means or used in any form except for the purpose for which it was intended. All rights of design and invention are hereby reserved.</small>			



13311 Main Road \* Akron \* New York \* 14001  
 Phone: (716) 542-3991 \* Fax: (716) 542-3996 \* E-mail: sales@eriemetal.com

PROJECT: \_\_\_\_\_

TITLE: ELCD-200/200W

Detailed by:	Date:
BAF	10/21/17
Checked by:	Date:
SLP	10/21/17
Scale:	EMS Job #:
NTS	
Sheet No.:	Drawing No.:
1 of 1	ELCD-1

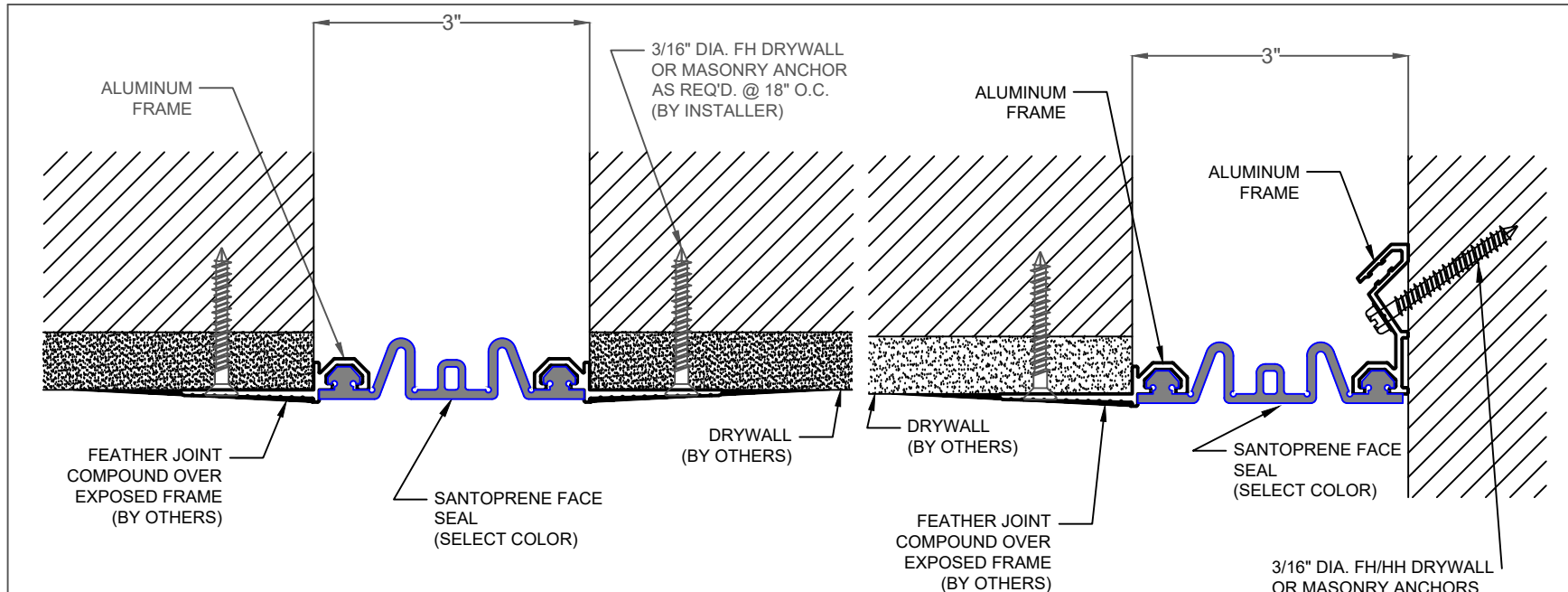

SEAL COLOR SELECTOR			
BLACK	_____	WHITE	_____
BEIGE	_____	GRAY	_____

**INTERIOR WALL & CLG. FLAT/CORNER DRYWALL SYS.**  
 MOVEMENT: +/- 50% NOMINAL JOINT WIDTH  
 STOCK LENGTHS: ALUMINUM FRAMES: 10'  
 SEAL: CONTINUOUS

PRODUCT	Application	Joint Size @ Mean T°F	Exposed Site line: IN (MM)	Total Movement IN (MM)
ELCD-300	Wall/Ceiling	3.00" (76)	3.00" (76)	3.00" (76)
ELCD-300W	Wall/Ceiling Corner	3.00" (76)	3.00" (76)	3.00" (76)

NO.	Description	Date	By
<small>The information contained herein is the proprietary property of ERIE METAL SPECIALTIES, INC. No portion of it may be reproduced by any means or used in any form except for the purpose for which it was intended. All rights of design and invention are hereby reserved.</small>			



13311 Main Road \* Akron \* New York \* 14001  
 Phone: (716) 542-3991 \* Fax: (716) 542-3996 \* E-mail: sales@eriemetal.com

PROJECT:
TITLE: ELCD-300/300W

Detailed by: BAF	Date: 10/21/17
Checked by: SLP	Date: 10/21/17
Scale: NTS	EMS Job #:
Sheet No.: 1 of 1	Drawing No.: ELCD-1

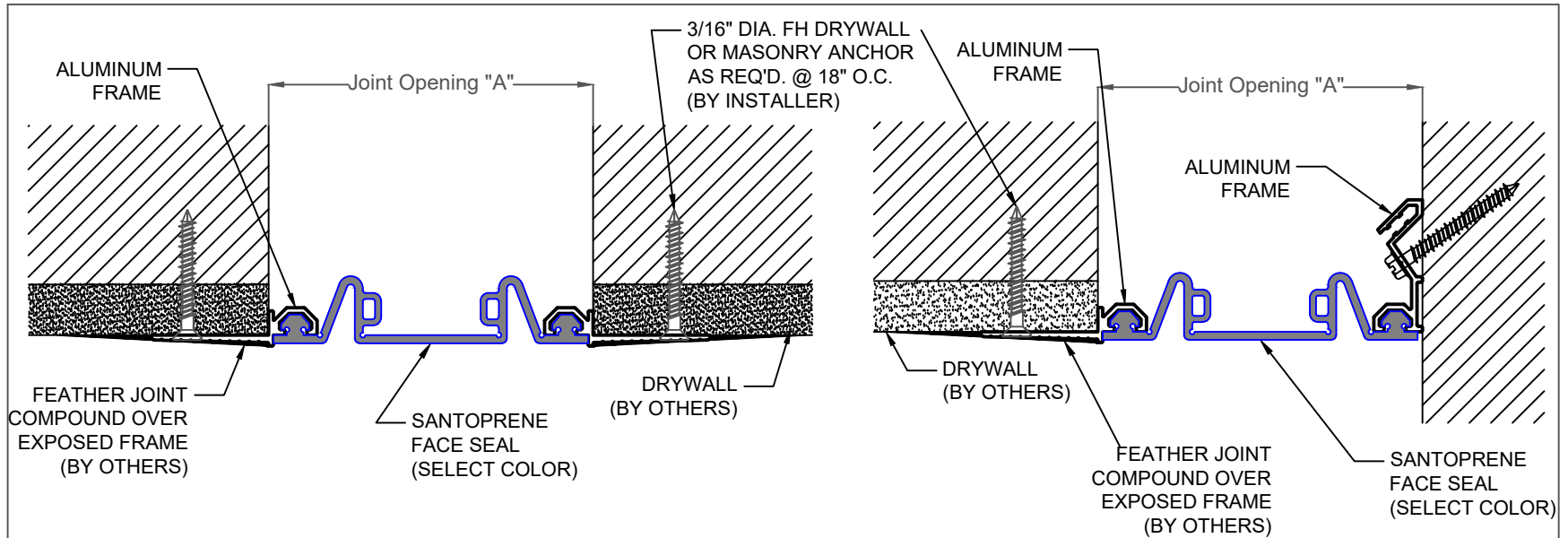

**SEAL COLOR SELECTOR**  
 BLACK \_\_\_\_\_ WHITE \_\_\_\_\_  
 BEIGE \_\_\_\_\_ GRAY \_\_\_\_\_

**INTERIOR WALL & CLG. FLAT/CORNER DRYWALL SYS.**

MOVEMENT: +/- 50% NOMINAL JOINT WIDTH  
 STOCK LENGTHS: ALUMINUM FRAMES: 10'  
 SEAL: CONTINUOUS

PRODUCT	Application	Joint Size "A" @ Mean T°F	Exposed Site line: IN (MM)	Total Movement IN (MM)
ELCD-400	Wall/Ceiling	4.00" (102)	4.00" (102)	4.00" (102)
ELCD-500	Wall/Ceiling	5.00" (127)	5.00" (127)	5.00" (127)
ELCD-600	Wall/Ceiling	6.00" (152)	6.00" (152)	6.00" (152)
ELCD-400W	Wall/Ceiling Corner	4.00" (102)	4.00" (102)	4.00" (102)
ELCD-500W	Wall/Ceiling Corner	5.00" (127)	5.00" (127)	5.00" (127)
ELCD-600W	Wall/Ceiling Corner	6.00" (152)	6.00" (152)	6.00" (152)

NO.	Description	Date	By
<small>The information contained herein is the proprietary property of ERIE METAL SPECIALTIES, INC. No portion of it may be reproduced by any means or used in any form except for the purpose for which it was intended. All rights of design and invention are hereby reserved.</small>			



13311 Main Road \* Akron \* New York \* 14001  
 Phone: (716) 542-3991 \* Fax: (716) 542-3996 \* E-mail: sales@eriemetal.com

PROJECT: \_\_\_\_\_

TITLE: ELCD-400/400W, 500/500W, 600/600W

Detailed by: BAF	Date: 10/21/17
Checked by: SLP	Date: 10/21/17
Scale: NTS	EMS Job #:
Sheet No.: 1 of 1	Drawing No.: ELCD-1