

ALCP-Series

Description

The ALCP-Series aluminum cover plates are designed especially for areas where no flooring material is used. The cover plate bridges the joint gap with minimal preparation for maximum protection. All of the cover plate selections are compliant with ADA requirements.

The ALCP Series is made from 6061-T6 aluminum alloy that is secured on one side of the floor by pre-drilled, countersunk holes, anchored into the concrete.

Recommended areas for use include warehouses, manufacturing facilities, retail spaces, and stock rooms, where the finished floor is concrete. Additionally, they are used in architectural applications where the cover plate must provide safe passage over expansion joint voids and must also accent the interior application.

Optional accents such as color anodize and EPDM-looped moisture barriers are available.

LEED Credits - One (1) LEED credit depending on the location of the project.

Features and Benefits

Ease of Installation – The layout of the anchor holes along the edge of the plate is a simple process. String line a straight edge parallel to the joint opening. Align the plate holes over the center of the string line and match drill for the anchors. Remove the plate. Clean out all the dust and debris. Place plate into position and install anchors.

Designed For Top Mount or Recessed – Either application may be accommodated. Each side has the required ADA slope for the thickness of the plate used.

Tested To ASTM D-1399 – The design was tested in compression, tension, and deflection for 500 cycles. No loss of anchors was noted.

Meets ADA Dictates – The ALCP Series profiles are engineered to meet ADA standards for pedestrian concerns.

Floor-to-Floor

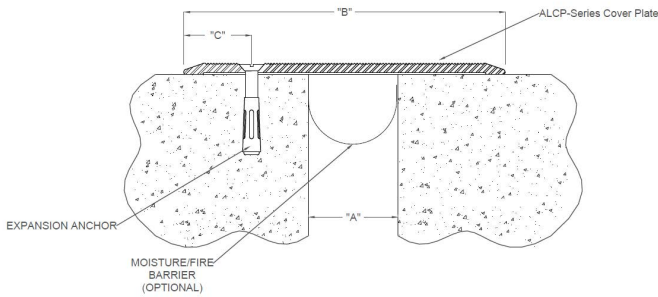

Floor-to-Wall

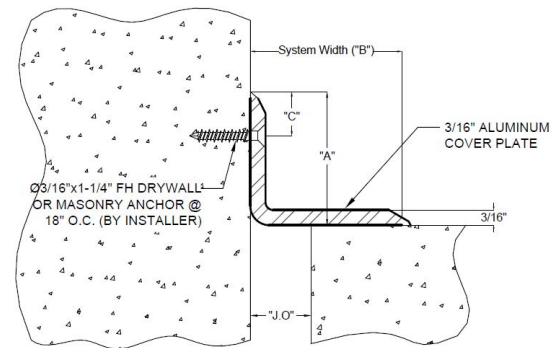

PRODUCT	Joint Size "A" @ Install IN (MM)	Max Width "A" at Install IN (MM)	Total Movement IN (MM)	System Width "B" IN (MM)	"C" IN (MM)
ALCP-100	1.00" (25)	1.50" (38)	1.00" (25)	4.00" (102)	0.75" (19)
ALCP-200	2.00" (51)	4.00" (102)	3.50" (89)	6.00" (152)	1.00" (25)
ALCP-300	3.00" (76)	7.00" (178)	5.50" (140)	8.00" (203)	1.25" (32)
ALCP-400	4.00" (102)	8.00" (203)	6.00" (152)	10.00" (254)	1.25" (32)
ALCP-500	5.00" (127)	10.00" (254)	9.00" (229)	12.00" (305)	1.25" (32)
ALCP-600 (Traffic Grade)	6.00" (152)	12.00" (305)	10.00" (254)	14.00" (356)	1.50" (38)

PRODUCT	System Height "A" IN (MM)	Joint Size "J.O." at Mean T°F	Total Movement IN (MM)	System Width "B" IN (MM)	"C" IN (MM)
ALCPW-100	2.00" (50.8)	1.00" (25)	2.00" (50.8)	2.00" (50.8)	0.75" (19)
ALCPW-200	2.00" (50.8)	2.00" (50.8)	4.00" (102)	3.50" (88.9)	0.75" (19)
ALCPW-300	2.00" (50.8)	3.00" (76)	6.00" (152)	5.00" (127)	0.75" (19)
ALCPW-400	2.00" (50.8)	4.00" (102)	8.00" (203)	6.50" (165.1)	0.75" (19)
ALCPW-600	2.00" (50.8)	6.00" (152)	12.00" (305)	9.50" (241.3)	0.75" (19)