

ELCS Series - Surface Application

Interior Joints (Wall/Ceiling)

FEATURES

MAXIMUM MOVEMENT "V" seal design allows for maximum thermal and seismic movement

CONTINUOUS SIGHT LINE This system can be used on wall, ceilings and corners to provide seamless and continuous aesthetics.

DETAILS

MATERIAL 6063-T5 Aluminum, Meets ASTM B209

FINISH Mill

MOVEMENT

- Thermal: Horizontal and Vertical
- Seismic: Lateral Shear

MOUNTING Surface

JOINT SIZE 2 inches to 6 inches

LENGTH Continuous

APPLICATION Interior

INSTALLATION Wall or Ceiling

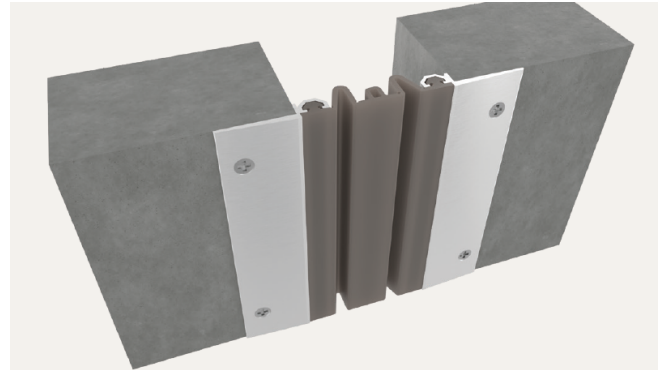

WALL/CEILING-TO-CORNER

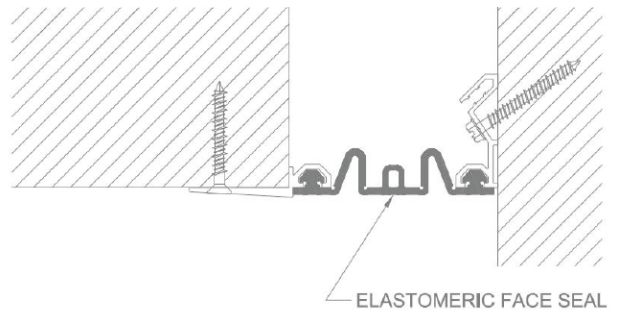

WALL/CEILING-TO-WALL/CEILING

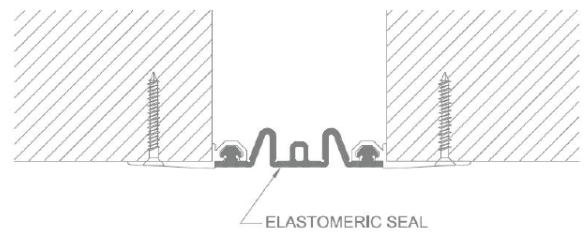

SEAL COLORS

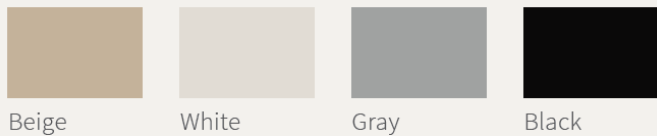

MODELS

MODEL	APPLICATION	JOINT SIZE AT MEAN T°F	EXPOSED SIGHT LINE	TOTAL MOVEMENT
ELCS-200	Wall/Ceiling to Wall/Ceiling	2" (51mm)	4.87" (124mm)	2" (51mm)
ELCS-300	Wall/Ceiling to Wall/Ceiling	3" (76mm)	5.87" (149mm)	3" (76mm)
ELCS-400	Wall/Ceiling to Wall/Ceiling	4" (102mm)	6.87" (175mm)	4" (102mm)
ELCS-500	Wall/Ceiling to Wall/Ceiling	5" (127mm)	7.87" (200mm)	5" (127mm)
ELCS-600	Wall/Ceiling to Wall/Ceiling	6" (152mm)	8.87" (226mm)	6" (152mm)
ELCS-200W	Wall/Ceiling to Corner	2" (51mm)	3.5" (87mm)	2" (51mm)
ELCS-300W	Wall/Ceiling to Corner	3" (76mm)	4.5" (113mm)	3" (76mm)
ELCS-400W	Wall/Ceiling to Corner	4" (102mm)	5.5" (138mm)	4" (102mm)
ELCS-500W	Wall/Ceiling to Corner	5" (127mm)	6.5" (164mm)	5" (127mm)
ELCS-600W	Wall/Ceiling to Corner	6" (152mm)	7.5" (189mm)	6" (152mm)



Erie Metal Specialties, Inc.
13311 Main Road
Akron, NY 14001

Phone: 716-542-3991
Website: www.eriemetal.com
E-Mail: sales@eriemetal.com