

ELCWM Series Corridor System

Interior Joints (Wall)

Designed for drywall corner applications, this Elastomeric Corridor Corner System limits the sight line of the expansion joint by using a drywall bead. The system is mounted to the outside of the joint opening with a finished tape and mud process, while maintaining the elegance of exposed aluminum corner plate. The Santoprene seal comes in four colors to match your surroundings.

FEATURES

COMPLEMENTARY SEAL COLORS Available in four elastomeric seal color options: beige, white, gray or black.

QUICKER INSTALLATION Reduce installation time and labor costs with fast and easy installation.

CONTINUOUS SIGHT LINE This system can be used on walls, ceilings and corners to provide seamless and continuous aesthetics.

DETAILS

MATERIAL 6063-T6 Aluminum with Rubber Seal

FINISH Mill

MOVEMENT

- Thermal: Horizontal

MOUNTING Flush with Drywall Bead

JOINT SIZE 1 inch to 2 inches

SEAL LENGTH Continuous

APPLICATION Interior

INSTALLATION Wall or Ceiling

OPTIONS Seal Color, Moisture Barrier, Fire Barrier

MODELS

MODEL	JOINT SIZE AT MEAN T°F	SYSTEM WIDTH	TOTAL MOVEMENT
ELCWM-100	1" (25mm)	1" (25mm)	.5" (13mm)
ELCWM-200	2" (51mm)	2" (51mm)	1" (25mm)



SEAL COLORS



Beige

White

Gray

Black

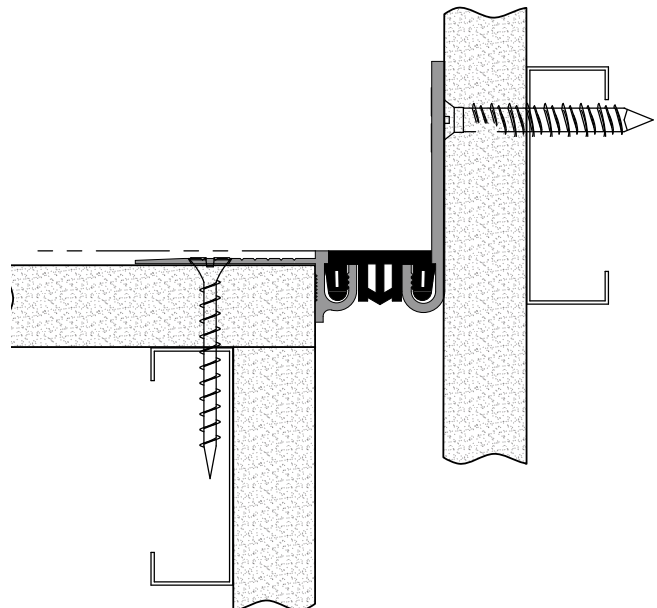

Wall/Ceiling Corner



Erie Metal Specialties, Inc.
13311 Main Road
Akron, NY 14001

Phone: 716-542-3991
Website: www.eriemetal.com
E-Mail: sales@eriemetal.com