

ESFC Series Seismic System (Blockout Top Plate)

The Architectural Seismic System is designed to cover expansion control openings in structural, high movement floor joints, when standard aluminum is acceptable.

FEATURES

SEISMIC TECHNOLOGY The cover plate stays centered over openings before, during and after a seismic event with the use of the seismic centering bar.

ADA COMPLIANT Heavy-duty loading requirements are met while maintaining a smooth ADA compliant transition.

DETAILS

MATERIAL

6063-T5 Aluminum, Meets ASTB B221

6061-T6 Aluminum, Meets ASTM B209

5052-H32 Aluminum, Meets ASTM B209

FINISH Mill

MOVEMENT

- Thermal: Horizontal and Vertical
- Seismic: Lateral Shear

MOUNTING Block Out

JOINT SIZE 2 inches to 12 inches

LENGTH 10 Linear Feet

APPLICATION Interior

LOAD Pedestrian and Light Cart

INSTALLATION Floor

OPTIONS Moisture Barrier, Fire Barrier

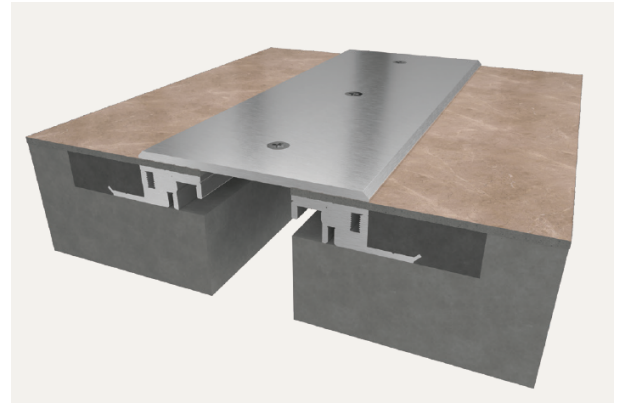

FLOOR-TO-WALL-CORNER

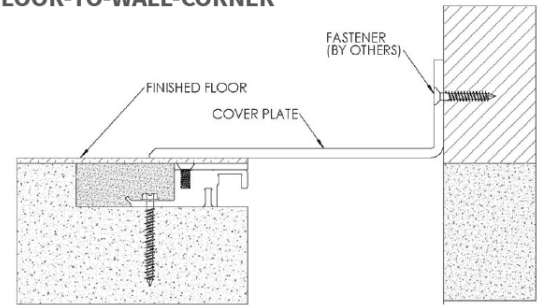

FLOOR-TO-FLOOR

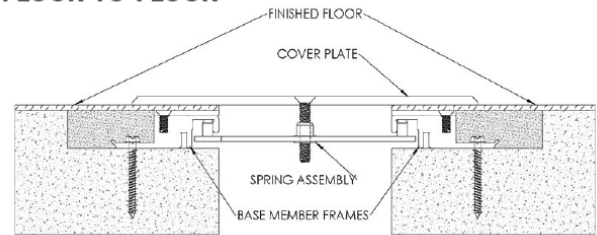

MODELS

MODEL	APPLICATION	JOINT SIZE AT MEAN T°F	EXPOSED SIGHT LINE	TOTAL MOVEMENT
ESFC-200	Floor to Floor	2" (51mm)	5" (127mm)	2" (51mm)
ESFC-400	Floor to Floor	4" (102mm)	8" (203mm)	4" (102mm)
ESFC-600	Floor to Floor	6" (152mm)	11" (279mm)	6" (152mm)
ESFC-800	Floor to Floor	8" (203mm)	14" (356mm)	8" (203mm)
ESFC-1000	Floor to Floor	10" (254mm)	17" (432mm)	10" (254mm)
ESFC-1200	Floor to Floor	12" (305mm)	20" (508mm)	12" (305mm)
ESFC-200W	Floor to Wall	2" (51mm)	3.5" (89mm)	1" (25mm)
ESFC-400W	Floor to Wall	4" (102mm)	6" (152mm)	2" (51mm)
ESFC-600W	Floor to Wall	6" (152mm)	8.5" (216mm)	3" (76mm)
ESFC-800W	Floor to Wall	8" (203mm)	11" (279mm)	4" (102mm)
ESFC-1000W	Floor to Wall	10" (254mm)	13.5" (343mm)	5" (127mm)
ESFC-1200W	Floor to Wall	12" (305mm)	16" (406mm)	6" (152mm)

