

FLOOR-TO-FLOOR SINGLE WING INFILL SYSTEM

EXPOSED FINISH: MILL

MOVEMENT: +/- 5/8"

STOCK LENGTHS: 10'-0"

INFILL: 1/8" [3mm]

PRODUCT	Application	MAX Joint Size @ Mean T°F	Exposed Sight Line	Infill Height	Total Movement IN (MM)
ESA150-125	Floor-Floor	2.00" (51)	1.50" (38)	0.125" (3)	1.25" (32)

NO.	Description	Date	By
<small>The information contained herein is the proprietary property of ERIE METAL SPECIALTIES, INC. No portion of it may be reproduced by any means or used in any form except for the purpose for which it was intended. All rights of design and invention are hereby reserved.</small>			



13311 Main Road * Akron * New York * 14001
 Phone: (716) 542-3991 * Fax: (716) 542-3996 * E-mail: sales@eriemetal.com

PROJECT:

TITLE: ESA150-125 Single Wing Infill System

Detailed by:	Date:
BAF	10/21/17
Checked by:	Date:
SLP	10/21/17
Scale:	EMS Job #:
NTS	
Sheet No.:	Drawing No.:
1 of 1	ESA150125

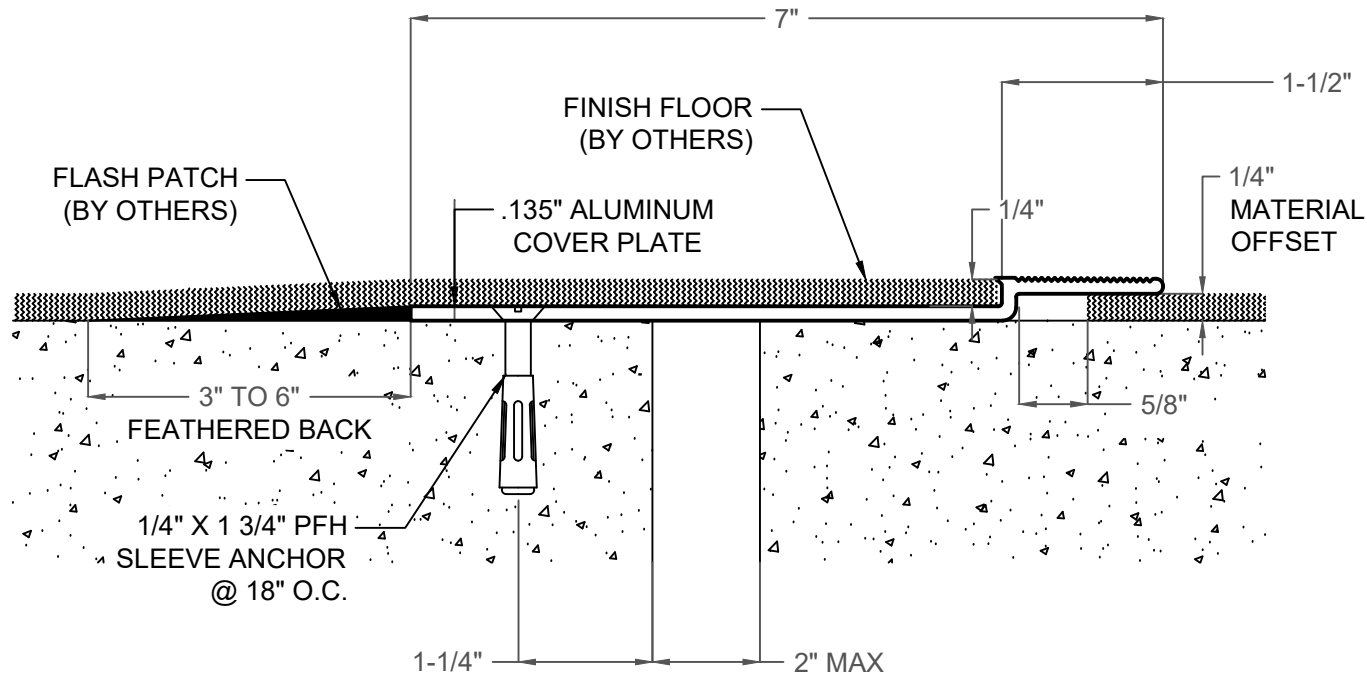

FLOOR-TO-FLOOR SINGLE WING INFILL SYSTEM

EXPOSED FINISH: MILL

MOVEMENT: +/- 5/8"

STOCK LENGTHS: 10'-0"

INFILL: 1/4" [6mm]

PRODUCT	Application	MAX Joint Size @ Mean T°F	Exposed Sight Line	Infill Height	Total Movement IN (MM)
ESA150-250	Floor-Floor	2.00" (51)	1.50" (38)	0.25" (6)	1.25" (32)

NO.	Description	Date	By
<small>The information contained herein is the proprietary property of ERIE METAL SPECIALTIES, INC. No portion of it may be reproduced by any means or used in any form except for the purpose for which it was intended. All rights of design and invention are hereby reserved.</small>			



13311 Main Road * Akron * New York * 14001
Phone: (716) 542-3991 * Fax: (716) 542-3996 * E-mail: sales@eriemetal.com

PROJECT:

TITLE: ESA150-250 Single Wing Infill System

Detailed by:	Date:
BAF	10/21/17
Checked by:	Date:
SLP	10/21/17
Scale:	EMS Job #:
NTS	
Sheet No.:	Drawing No.:
1 of 1	ESA150250

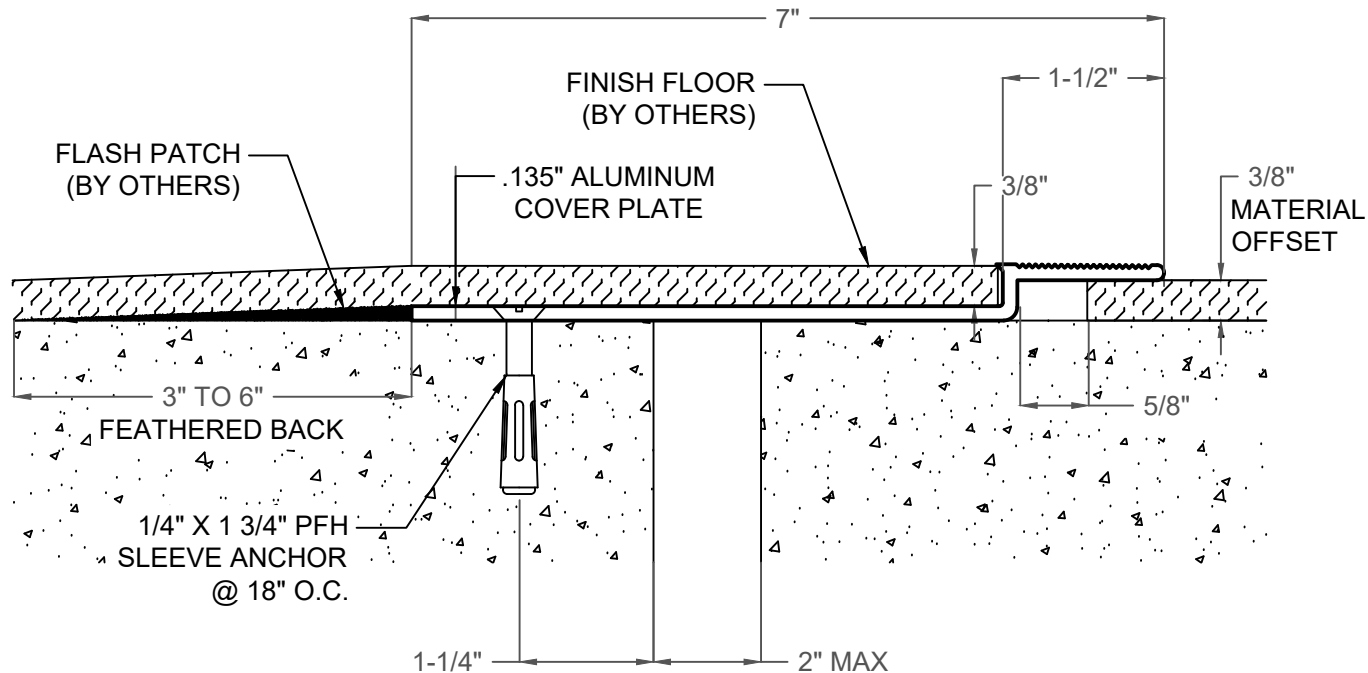

FLOOR-TO-FLOOR SINGLE WING INFILL SYSTEM

EXPOSED FINISH: MILL

MOVEMENT: +/- 5/8"

STOCK LENGTHS: 10'-0"

INFILL: 3/8" [10mm]

PRODUCT	Application	MAX Joint Size @ Mean T°F	Exposed Sight Line	Infill Height	Total Movement IN (MM)
ESA150-375	Floor-Floor	2.00" (51)	1.50" (38)	0.375" (10)	1.25" (32)

NO.	Description	Date	By
<small>The information contained herein is the proprietary property of ERIE METAL SPECIALTIES, INC. No portion of it may be reproduced by any means or used in any form except for the purpose for which it was intended. All rights of design and invention are hereby reserved.</small>			



13311 Main Road * Akron * New York * 14001
Phone: (716) 542-3991 * Fax: (716) 542-3996 * E-mail: sales@eriemetal.com

PROJECT:

TITLE: ESA150-375 Single Wing Infill System

Detailed by:	Date:
BAF	10/21/17
Checked by:	Date:
SLP	10/21/17
Scale:	EMS Job #:
NTS	
Sheet No.:	Drawing No.:
1 of 1	ESA150375